



Dividers, elbows, valves

Valves, dividers and elbows at a glance	249	Dividers (4-way) with ball valves "QUADRIPOK"	273
Valves - Full waterway "MONOPOK"	250	Dividers (5-way) with ball valves "PENTAPOK"	274
Valves	254	Dividers (2-way) with flywheel valves	275
B-druckventil	258	Dividers (3-way) with flywheel valves	277
Schlauchanschlussarmatur & Schlauchanschlußventil	259	Dividers and Standpipes - Spare parts	279
Non-return valves	260	Standpipes	281
Siameses - Clappered	261	Standpipes - Spare parts	283
Dividers (2-way) without shutoff	265	Keyser elbows	286
Dividers (3-way) without shutoff	267	Keyser valves	286
Dividers (2-way) with ball valves "BIPOK"	268	Elbows	287
Dividers (3-way) with ball valves "TRIPOK"	271		



Our nozzles, monitors, foam equipments, dividers can be equipped with all types of couplings existing all over the world and manufactured by POK using the best materials.

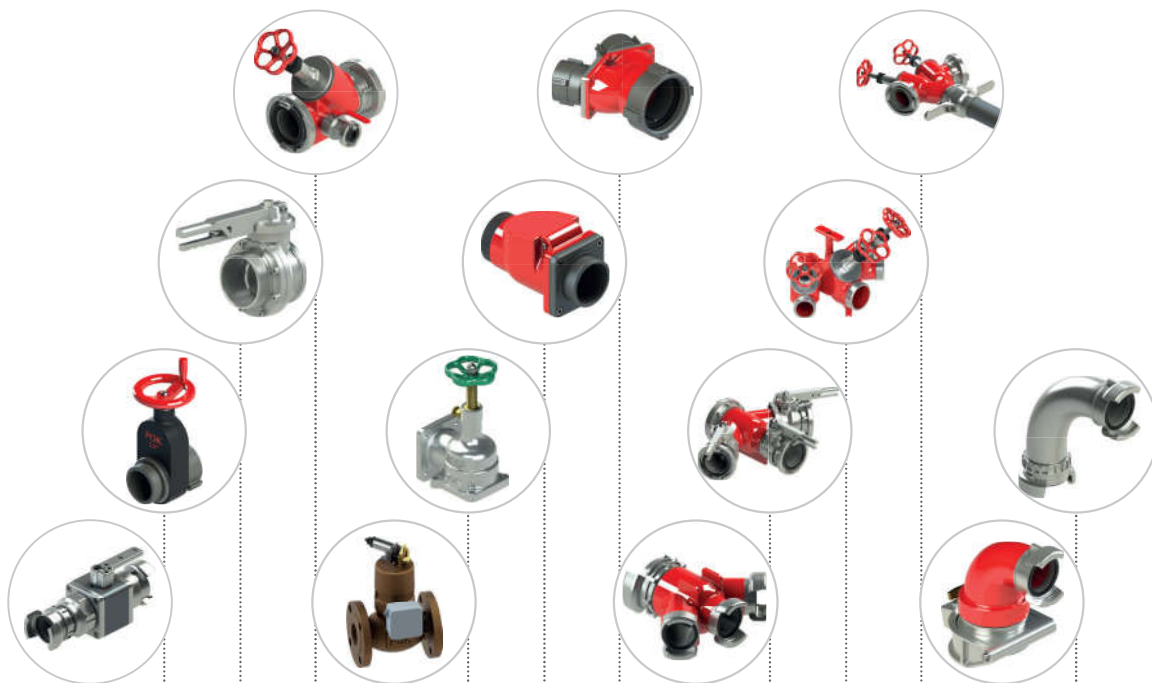

	"Monopak" full waterway valves	Gated valve	Butterfly valves and isolating valves	Mobile valves for ladder	Automatic opening valves "DELUGE VALVE"	DIN valves	Non-return valves	Clappered siamese	Dividers without shutoff	Dividers with ball valve shutoffs	Dividers with flywheel valves	Standpipes	"KEYSER" elbows	Elbows
Working pressure (bar)	16	16	16	16	16	16	16 - 25	16 - 25	16 - 25	16 - 25	16 - 25	16	16	16 - 25
Waterway	from 25 mm to 80 mm	from 60 mm to 110 mm	from 80 mm to 150 mm	from 40 mm to 100 mm	25 mm	from 40 mm to 60 mm	from 40 mm to 110 mm	from 60 mm to 110 mm	from 50 mm to 160 mm	from 35 mm to 160 mm	from 40 mm to 110 mm	50 mm and 80 mm	100 mm	from 35 mm to 150 mm
Material	Alu Stainless steel	Alu Bronze	Alu Cast iron	Alu	Bronze	Alu Brass	Alu	Alu	Alu	Alu Bronze	Alu	Alu	Alu	Alu Bronze Stainless steel
Hard anodisation	(•)	(•)				(•)	(•)	•	•	•	•	•	•	(•)
Polyester coating			(•)	•		(•)	(•)	•	•	•	•	•	•	(•)
Rilsan coated														
Number of inlets	1	1	1	1	1	1	1	2-3-4	1	1-2	1	1	1	1
Numer of outlets	1	1	1	1	1	1	1	1	2-3	2-3-4-5	2-3	1-2	1 or 2	1
Ball valve	•									(•)				
Butterfly valve			•							(•)				
Flywheel valve				•	•	•		•		(•)	•	(•)	(•)	
Gated valve		•												
Flush				•										
Non-return valve						•	•	•						
Operation by lever	•		•	•						•				
Operation by flywheel		•		•		•					•	•	•	
Operation by sprinkler or electrical					•									
Page	251-253	254	255	256	257	258-259	260	261-263	265-267	268-274	275-280	279-285	286	287-288

(•): Depending on reference

Good modularity
Interchangeable
Parts

The "Monopok" valve is a 1/4 turn ball valve shutoff, with full waterway, made of an aluminium alloy section heat-treated. The whole is machined on a computerised and automated machine tool, which guarantees a precision and an unequalled manufacturing quality.

It is designed to be used as a suction or discharge ball valve.

To allow you to adapt to any situation, the Monopok shutoff offers multiple configurations.

The main feature to choose is the waterway diameter: **DN25, DN40, DN65 or DN80.**

You can also choose the raw material of the ball valve: **Aluminium anodised** (as standard for the whole range), **stainless steel** or **polyamid**.

The choice of the control handle is also crucial, depending on the use of your Monopok. You can choose between the shapes and lengths (below) for a **direct control** or a **remote control**.

As standard, the "Monopok" valves come with BSP thread inlets and outlets but POK SAS offers a full range of couplings made according to the international standards to mount on the "Monopok" valves: symmetrical Guillemín couplings DN25, DN32, DN40, DN50, DN65, symmetrical DSP couplings DN40, DN50, DN65, Storz couplings D/25, C/52 or B/75, instantaneous couplings 1,5" or 2,5".

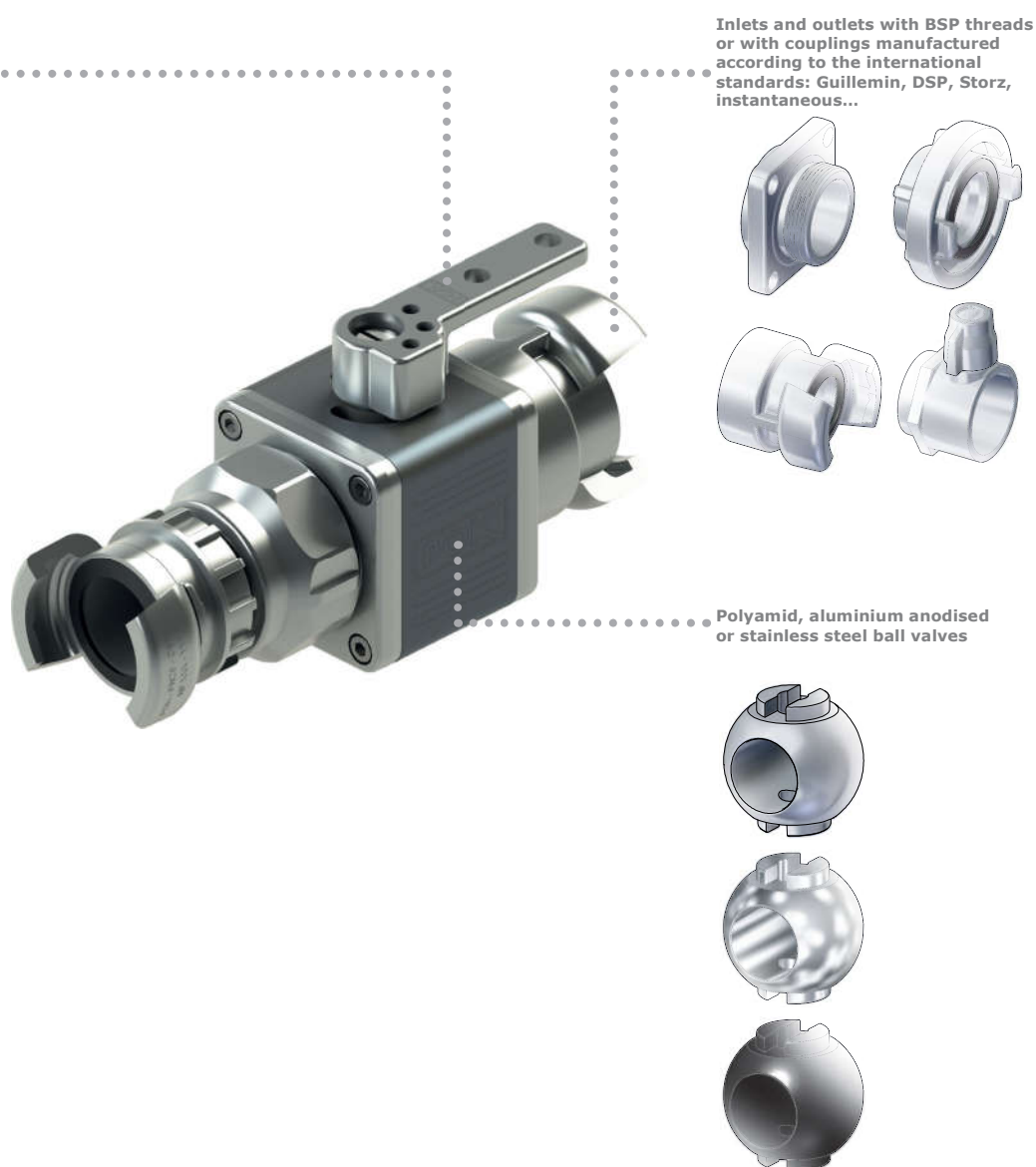
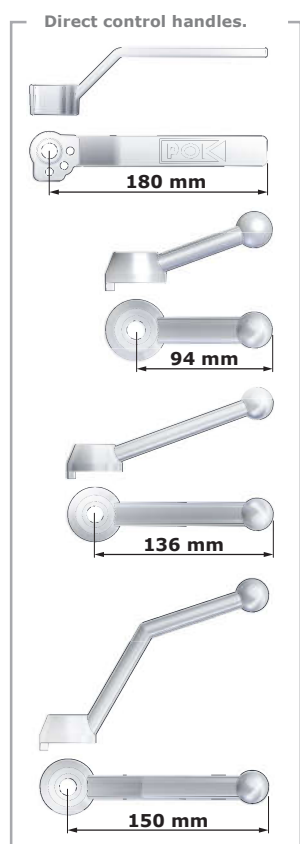
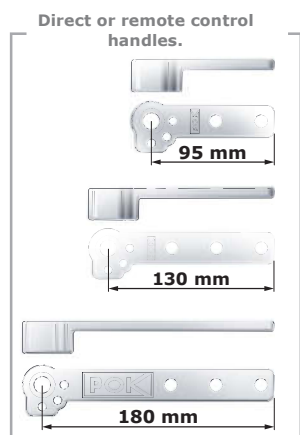

The "Monopok" valve features outstanding technical characteristics:

- **Minimal pressure loss**
- **Low handling effort**
- **Light weight and smaller dimension design**

The "Monopok" valve can be fully disassembled which enables very easy maintenance by the user.

To conclude, each "Monopok" valve is assembled by a highly qualified technician and it is hydraulically tested to be sure of its perfect working order.

The "Monopok" valve is a 1/4 turn ball valve shutoff, with full waterway, made of an aluminium alloy section heat-treated. It is designed to be used as a suction or discharge ball valve and offers many adaptation possibilities.

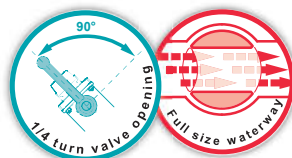

Maximum working pressure: PN16
Valve type: ball valve
Operation: by lever
Material: aluminium alloy
Coating: hard anodisation
Body type: cut into bar

Options: inlet/outlet couplings, operating handle length, ball material.

"Monopok" DN25

Please specify the control handle type, the material of the ball valve and the type of couplings when placing the order.



Inlet	Outlet	Waterway Ø (mm)	Dimensions (mm)	Weight (kg)	Ref.
1" BSP male	1" BSP male	25	146 x 74 x 106	1,06	11749.FM

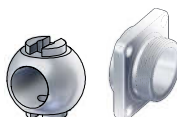
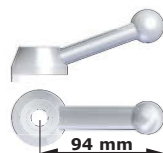

As standard, the "Monopok" DN25 is delivered with a direct or remote control handle of 95mm and a ball valve in aluminium alloy and it has 1" BSP thread at the inlet and at the outlet.

"Monopok" DN40

Please specify the control handle type, the material of the ball valve and the type of couplings when placing the order.



Inlet	Outlet	Waterway Ø (mm)	Dimensions (mm)	Weight (kg)	Ref.
1.5" BSP male	1.5" BSP male	35	155 x 83 x 118	1,44	11902.FM

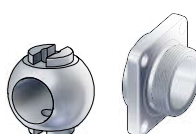

As standard, the "Monopok" DN40 is delivered with a direct or remote control handle of 95mm and a ball valve in aluminium alloy and it has 1" BSP thread at the inlet and at the outlet.

"Monopok" DN65

Please specify the control handle type, the material of the ball valve and the type of couplings when placing the order.



Inlet	Outlet	Waterway Ø (mm)	Dimensions (mm)	Weight (kg)	Ref.
2" BSP male	2" BSP male	52	204 x 103 x 138	2,34	11921.FM

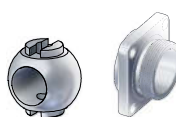

As standard, the "Monopok" DN65 is delivered with a direct or remote control handle of 130mm and a ball valve in aluminium alloy and it has 2" BSP thread at the inlet and at the outlet.

"Monopok" DN80

Please specify the control handle type, the material of the ball valve and the type of couplings when placing the order.



Inlet	Outlet	Waterway Ø (mm)	Dimensions (mm)	Weight (kg)	Ref.
3" BSP male	3" BSP male	62	208 x 122 x 152	3,50	12024.FM



As standard, the "Monopok" DN80 is delivered with a direct or remote control handle of 130mm and a ball valve in aluminium alloy and it has 2.5" BSP thread at the inlet and at the outlet.

"Monopok" full waterway valves - DN150

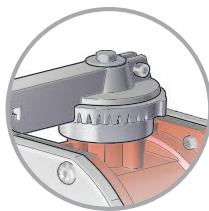

Lever with locking notches by step of 10°

Maximum working pressure: PN16
Valve type: ball valve
Operation: by lever
Material: aluminium alloy
Coating: polyester coating
Body type: moulded
Options: couplings inlet/outlet.

The "Monopok" valve is a full waterway shutoff with a butterfly valve, made of an aluminium alloy section with a polyester coating. The inlet and the outlet are male thread 6" BSP. It is designed to be used as a suction or discharge ball valve.

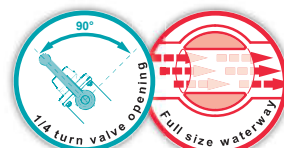

Inlet	Outlet	Waterway Ø (mm)	Dimensions (mm)	Weight (kg)	Ref.
6" BSP male	6" BSP male	150	391 x 256 x 328	17,99	24763

"Monopok" full waterway valves - in stainless steel



Maximum working pressure: PN16
Valve type: ball valve
Operation: by lever
Material: stainless steel
Body type: cast
Options: couplings inlet/outlet.

These "Monopok" are full waterway ball valve shutoffs made of stainless steel. They are designed to be used as suction or discharge ball valves. They feature outstanding technical characteristics: minimal pressure loss, low handling effort, light weight and smaller dimension design. The "Monopok" shutoffs are tested one by one.

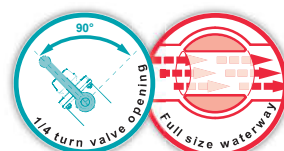

Inlet	Outlet	Waterway Ø (mm)	Dimensions (mm)	Weight (kg)	Ref.
3" BSP female	3" BSP female	80	322 x 128 x 210	12,25	18836
4" BSP female	4" BSP female	100	444 x 220 x 282	20,50	18837

"Flüssig" valve



Maximum working pressure: PN16
Valve type: ball valve
Operation: by lever
Material: aluminium alloy
Body type: moulded
Options: couplings inlet/outlet.

Those "FLÜSSIG" valves are ball valves, with full size waterway, built in aluminium alloy. Inlet and outlet are threaded or with normalized flange. The full size waterway ensure low pressure loss.

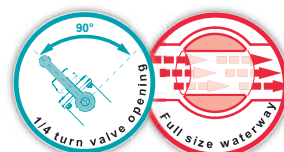

Inlet	Outlet	Waterway Ø (mm)	Dimensions (mm)	Weight (kg)	Ref.
Flange Tankwagen TW DN80 DIN 28462	Flange Tankwagen TW DN80 DIN 28462	80	140 x 154 x 244	5,06	33416
Flange Tankwagen TW DN80 DIN 28462	3" BSP male	80	160 x 154 x 244	4,80	33508

Repair kit - set of gaskets

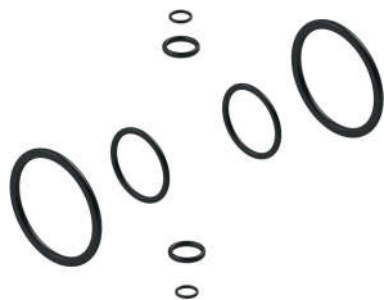

Material: nitrile

The repair kit for the "Monopok" valve includes all the gaskets which are necessary to refurbish a full waterway valve. The choice of the kit depends on the diameter of the valve waterway.

Waterway Ø (mm)	Ref.
25	07859
40	07860
65	07861
80	08350



Gated valve - aluminium alloy

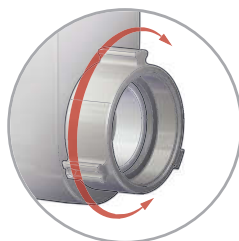

Swivel inlet coupling

Maximum working pressure: PN16
Valve type: gated valve
Operation: by flywheel
Material: aluminium alloy
Coating: hard anodisation
Body type: moulded

Options: couplings inlet/outlet.

Highly resistant gated valve with a monobloc body made in aluminium alloy hard anodised. It is available with different connections: swivel inlet female thread 2.5" NST-NH - outlet male thread 2.5" NST-NH or inlet with flange 4" ASA150 - outlet male thread 2.5" NST-NH. Metal-seated valves will not guarantee total waterproofness.



Inlet	Outlet	Waterway Ø (mm)	Dimensions (mm)	Weight (kg)	Ref.
2.5" NST-NH female	2.5" NST-NH male	60	127 x 120 x 287	3,70	12782

Gated valves - bronze



Maximum working pressure: PN16
Valve type: gated valve
Operation: by flywheel
Material: bronze and stainless steel
Body type: moulded

Options: couplings inlet/outlet.

Highly resistant gated valves with a monobloc body made in bronze and stainless steel. It is available with different connections: swivel inlet female thread 2.5" NST-NH - outlet male thread 2.5" NST-NH or inlet with flange 4" ASA150 - outlet male thread 2.5" NST-NH. Metal-seated valves will not guarantee total waterproofness.

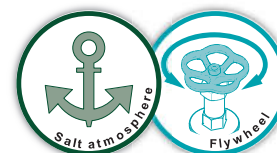

Inlet	Outlet	Waterway Ø (mm)	Dimensions (mm)	Weight (kg)	Ref.
Flange 2" ASA150	2" NST-NH male	50	108 x 152 x 240	4,42	32648
2.5" NST-NH female	2.5" NST-NH male	60	127 x 120 x 287		12784
AR DN100 with lock	AR DN100 with lock				16760
Flange 4" ASA150	4.5" NST-NH male	110	171 x 229 x 426	17,76	21253

Butterfly valves - DN100

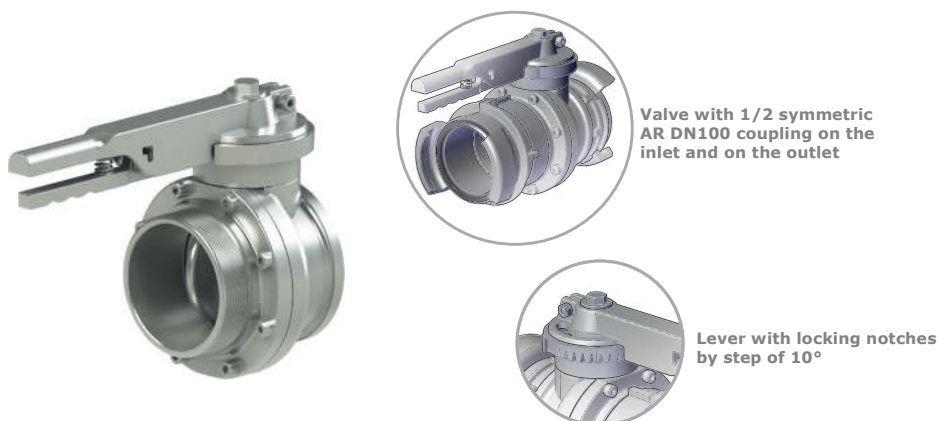

Maximum working pressure: PN16
Valve type: butterfly valve
Operation: by lever
Material: aluminium alloy
Body type: moulded

Options: couplings inlet/outlet.

Our range of isolating valves DN100 called "butterfly" valves is primarily made of aluminium alloy heat-treated. It is fitted with a control handle which enables to do a setting of the butterfly valve. This one can be indexed every 10° from the position "open valve" to the position "closed valve". All the parts which make up these valves can be disassembled and changed. A large number of inlet connections can be provided: threaded BSP or NST-NH, or standardised couplings.

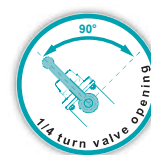

Inlet	Outlet	Dimensions (mm)	Weight (kg)	Ref.
4" BSP female	4" BSP male	303 x 160 x 230	3,76	00879
AR DN100 with lock	AR DN100 with lock	373 x 160 x 230	5,99	16879

Isolating valves



Maximum working pressure: PN16
Valve type: butterfly valve
Operation: by lever
Material: cast iron
Coating: rilsan coated
Body type: moulded

Our range of isolating valves for connection between flanges goes from DN80 to DN150. The construction in cast iron with a rilsan coating makes these valves particularly resistant.

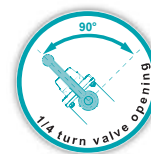

Assembly on flanges	Waterway Ø (mm)	Dimensions (mm)	Weight (kg)	Ref.
DN80 PN16	80	249 x 88 x 347	4,60	07404
DN100 PN16	100	249 x 88 x 375	6,00	09534
DN150 PN16	150	383 x 105 x 443	9,20	16641

Mobile valves for ladder with flush - flywheel shutoff

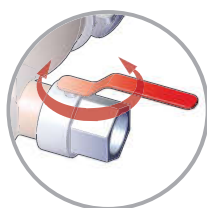

1/4 turn flush manoeuvred by lever

Maximum working pressure: PN16
Valve type: by flywheel valve
Operation: by flywheel
Material: aluminium alloy
Coating: polyester coating
Body type: moulded

Options: couplings inlet/outlet.

Our range of mobile valves for a ladder are made primarily in heat-treated aluminium alloy. Designed to be connected at the bottom of a hose installed on a ladder, the device allows water to drain thanks to a flush equipped with a 1/4 turn ball valve shutoff.

All spare parts can be dismantled and are interchangeable.

A large number of in and outlet connections can be provided: threaded BSP or NST-NH, or standardised couplings.

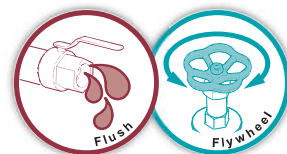

Inlet	Outlet	Flush	Dimensions (mm)	Weight (kg)	Ref.
DSP DN40	DSP DN40	GFR DN20 male	266 x 97 x 339	1,82	07461
DSP DN65	DSP DN65	GFR DN20 male	295 x 224 x 298	2,60	07460
DSP DN65	DSP DN65	SG DN20	295 x 224 x 298	2,73	07462
2.5" BSP male	2.5" BSP female	1" BSP female	257 x 219 x 298	1,99	07463
Storz B/75	Storz B/75	Storz D/25	295 x 232 x 298	2,91	16559
DSP DN40, with lock	DSP DN40, with lock	GFR DN20 male	340 x 97 x 339	2,26	07461.AV
DSP DN65, with lock	DSP DN65, with lock	GFR DN20 male	342 x 197 x 270	3,25	07460.AV

Mobile valves for ladder with flush - 1/4 turn ball valve shutoff



Maximum working pressure: PN16
Valve type: butterfly valve
Operation: by lever
Material: aluminium alloy
Coating: hard anodisation
Body type: cut into bar / moulded

Options: couplings inlet/outlet.

Our range of mobile valves for a ladder are made primarily in heat-treated aluminium alloy. Designed to be connected at the bottom of a hose installed on a ladder, the device allows to drain water thanks to a flush equipped with a 1/4 turn ball valve shutoff.

All spare parts can be dismantled and are interchangeable.

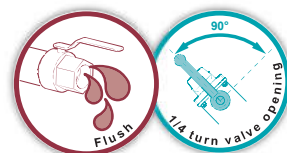

Inlet	Outlet	Flush	Dimensions (mm)	Weight (kg)	Ref.
AR DN100, with lock	AR DN100, with lock	SG DN20	376 x 224 x 230	7,20	16394

Automatic opening valves "DELUGE VALVE"



Maximum working pressure: PN16
Valve type: with clapper
Operation: by sprinkler or electrical
Material: bronze
Body type: moulded

This automatic opening valve is made of bronze, PN16. The opening of the valve can be caused by the sprinkler, which breaks when temperature comes higher than 93°C, or by the 48 volts electrical firing pin.

Inlet	Outlet	Dimensions (mm)	Weight (kg)	Ref.
Flange 2" ASA150	Flange 2" ASA150	266 x 97 x 339	1,82	27965



In compliance with the norm
DIN 14 381-F.90
and
DIN 14 381-G.80K - 2B

These valves made of aluminium alloy are DIN 14 381 approved. Two versions exist: square flange outlet or BSP thread outlet with an angle of 80°.

A latch allows to unlock the wheel in order to flush the valve.

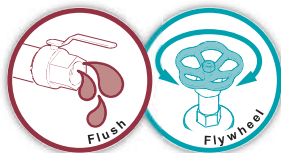

TÜV certificates numbers TRF 2/13 and 1/13

Maximum working pressure: PN16
Material: aluminium alloy
Body type: moulded

B-Druckventil PN16 - Outlet BSP thread



Outlet	Dimensions (mm)	Weight (kg)	Ref.
2.5" BSP male	140 x 124 x 225	1,61	28944

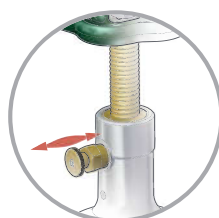

Unlocking of the flush

B-Druckventil PN16 - Outlet square flange



Outlet	Dimensions (mm)	Weight (kg)	Ref.
Square flange G 80 K	144 x 124 x 225	1,95	28918

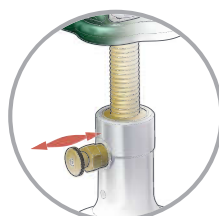

Unlocking of the flush

Schlauchanschlussarmatur & Schlauchanschlußventil



Schlauchanschlussarmatur

In compliance with the norm
DIN 14 461-5

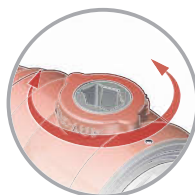

Standardized print to open the valve with position marking



TÜV certificate
Number TRF 1/15

This valve for dry standpipes is compliant with the DIN 14 461-5 norm. It is primarily made of heat treated aluminium alloy and equipped with a standardized printed opening device.

Maximum working pressure: PN16
Material: aluminium alloy
Coating: polyester coating
Body type: moulded

Inlet	Outlet	Dimensions (mm)	Weight (kg)	Ref.
2" BSP male	2" BSP male	129 x 94 x 182	1,39	28962

Schlauchanschlußventil - Brass

In compliance with the norm
DIN 14 461T.3



Maximum working pressure: PN16
Material: brass
Body type: moulded

These valves for dry or wet standpipes are made in compliance with the DIN 14 461 T3 norm. They are made of brass.

Inlet	Outlet	Dimensions (mm)	Weight (kg)	Ref.
1.25" BSP male	1" BSP male	129 x 76 x 125	1,07	32790
2" BSP male	2" BSP male	149 x 98 x 161	2,20	32751
2.5" BSP male	2.5" BSP male	257 x 110 x 158	2,37	24180

Our range of non-return valves with clapper is primarily made of heat treated aluminium alloy.
It combines compactness, total opening and perfect watertightness.

Maximum working pressure: PN16
Material: aluminium alloy
Coating: polyester coating
Body type: moulded
Options: couplings inlet/outlet.

Non-return valve with clapper



Inlet	Outlet	Dimensions (mm)	Weight (kg)	Ref.
1.5" BSP female	2" BSP female	113 x 72 x 78	0,47	03513
DSP DN65, without lock	2.5" BSP male	228 x 110 x 117	1,74	18405
2.5" BSP male	2.5" BSP male	200 x 104 x 117	1,78	18447
4" BSP male, swivel	4" BSP female	261 x 136 x 164	3,19	13940

Our range of axial non-return valves with clapper is primarily made of heat treated aluminium alloy and red polyester coating.
It combines compactness, total opening, and perfect watertightness.
A large number of in and outlet connections can be provided: threaded BSP or NST-NH, or standardised couplings.

Maximum working pressure: PN16
Material: aluminium alloy
Coating: polyester coating
Body type: moulded
Options: couplings inlet/outlet.

Axial non-return valve with clapper



Inlet	Outlet	Dimensions (mm)	Weight (kg)	Ref.
4" BSP female	4" BSP male	179 x 216 x 216	4,85	28451

Axial non-return valve with clapper and flush



Inlet	Outlet	Dimensions (mm)	Weight (kg)	Ref.
AR DN100, with lock	AR DN100, with lock	419 x 216 x 221	7,59	34502

Our range of clappered siamese is intended to join two fire hoses thanks to its two inlets. Its clapper allows an automatic closure in case of a water supply breaking.

Primarily made of heat treated aluminium alloy. A large number of in and outlet connections can be provided: threaded BSP or NST-NH, or standardised couplings.

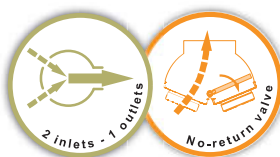

Maximum working pressure: PN16

Material: aluminium alloy

Coating: polyester coating

Body type: moulded

Non-return valve: YES

Options: couplings inlet/outlet.

2 inlets clappered siamese with threads

In compliance with the norm
NF E 03-005
(ISO R 228)



Inlets	Outlet	Dimensions (mm)	Weight (kg)	Ref.
2x 2" BSP male	2.5" BSP female	151 x 207 x 104	1,86	09676
2x 2.5" BSP male	2.5" BSP female	155 x 207 x 104	1,28	09677
2x 2.5" BSP male	4" BSP female	148 x 206 x 121	1,37	07489
2x 4" BSP male, swivel	4" BSP female	306 x 325 x 224	5,46	08900
2x 4" BSP male, swivel	6" BSP male	239 x 326 x 164	4,71	16153

2 inlets clappered siamese with DSP and AR couplings

Working pressure PN25 for dividers with inlet and outlet couplings with lock

In compliance with the norm
NF S 61-701



Inlets	Outlet	Dimensions (mm)	Weight (kg)	Ref.
2x DSP DN65, without lock	DSP DN65, with lock	283 x 256 x 107	2,91	07479
2x DSP DN65, without lock	AR DN100, with lock	155 x 207 x 104	3,37	02579
2x DSP DN65, with lock	AR DN100, with lock	323 x 292 x 152	4,10	02579.AV
2x AR DN100, swivel with lock	AR DN100, with lock	483 x 452 x 232	8,91	13292
2x AR DN100, swivel with lock	SG DN150, with lock	418 x 452 x 241	9,66	16093

2 inlets clappered siamese with NST-NH couplings

In compliance with the norm
NFPA 1963



Inlets	Outlet	Dimensions (mm)	Weight (kg)	Ref.
2x 2.5" NST-NH female	2.5" NST-NH male	244 x 253 x 107	2,38	08150
2x 2.5" NST-NH female	4" NST-NH male	228 x 230 x 151	3,04	08151
2x 4" NST-NH female, swivel	4" NST-NH male	322 x 362 x 191	7,36	10942

2 inlets clappered siamese with Storz couplings

Storz swivel and/or with catch on request

In compliance with the norm
DIN 14 355



Inlets	Outlet	Dimensions (mm)	Weight (kg)	Ref.
2x Storz C/52	Storz B/75	212 x 237 x 126	2,92	07994
2x Storz B/75	Storz A/110	228 x 264 x 182	3,71	07995
2x Storz DN100, swivel	Storz DN100	417 x 388 x 234	8,48	11103
2x Storz A/110, swivel	Storz A/110	387 x 411 x 247	8,98	13111
2x Storz A/110, swivel	Storz DN150	333 x 411 x 215	9,16	24724

2 inlets clappered siamese with Instantaneous couplings



Inlets	Outlet	Dimensions (mm)	Weight (kg)	Ref.
2x Instantaneous 2.5" male	Instantaneous 2.5" female	268 x 234 x 147	3,03	26142
2x Instantaneous 2.5" male	Storz A/110	239 x 233 x 182	3,32	07489.A110
2x Instantaneous 2.5" male	Storz DN125/5"	274 x 233 x 196	4,17	07489. STORZ125
2x Instantaneous 2.5" female	BSRT 5" male	294 x 234 x 147	5,00	28176



3 inlets clappered siamese

In compliance with the norm
For STORZ couplings
DIN 14355-4-3B

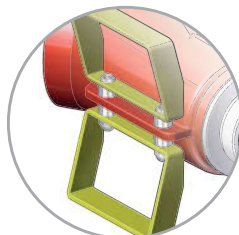

Carrying handle and stabilising feet

Maximum working pressure: PN16
Material: aluminium alloy
Coating: polyester coating
Body type: moulded
Non-return valve: YES
Options: couplings inlet/outlet.

Our range of clappered siamese is intended to join three fire hoses thanks to its three inlets. Its clapper allows an automatic closure in case of a water supply breaking. Primarily made of heat treated aluminium alloy. A large number of in and outlet connections can be provided: threaded BSP or NST-NH, or standardised couplings.

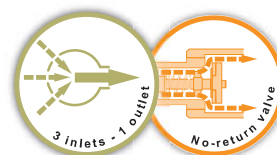

Inlets	Outlet	Dimensions (mm)	Weight (kg)	Ref.
3x 2.5" BSP male	4" BSP female	267 x 362 x 188	4,24	20352
3x Storz B/75	Storz A/110	349 x 367 x 188	6,54	19675

4 inlets clappered siamese

In compliance with the norm
For STORZ couplings
DIN 14355-4-3B

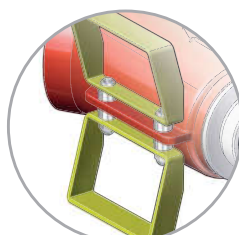

Carrying handle and stabilising feet

Maximum working pressure: PN16
Material: aluminium alloy
Coating: polyester coating
Body type: moulded
Non-return valve: YES
Options: couplings inlet/outlet.

Our range of clappered siamese is intended to join four fire hoses thanks to its four inlets. Its clapper allows an automatic closure in case of a water supply breaking. Primarily made of heat treated aluminium alloy. A large number of in and outlet connections can be provided: threaded BSP or NST-NH, or standardised couplings.

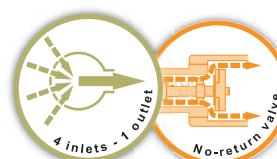

Inlets	Outlet	Dimensions (mm)	Weight (kg)	Ref.
4x 2.5" BSP male	4" BSP female	283 x 413 x 188	5,19	20353
4x Storz B/75	Storz A/110	358 x 455 x 188	8,20	19659

Our range of dividers are primarily made of heat treated aluminium alloy and red polyester coating. Their main function is to split one water supply into several outlets (two, three, four and more). The flow can be controlled by the flywheel valves or by the 1/4 turn ball valve shutoffs. These dividers have been designed to generate the least amount of pressure loss as possible and they offer several possible combinations.

All our dividers are equipped with couplings compliant with international norms:

Norm for the BSP threads of the dividers bodies

In compliance with the norm
NF E 03-005
(ISO R 228)

Norm for DSP couplings

In compliance with the norm
NF S 61-701

Norm for Storz couplings

In compliance with the norm
DIN 14 355

Norm for NST-NH threads

In compliance with the norm
NFPA 1963

- **2 or 3-way dividers without shutoff:** This range of dividers can be adapted to a large range of couplings (DSP, Storz, Guillemin, NST-NH, etc...) and have been designed to be used without any position constraint thanks to the moulded feet on both sides of the body.
- **« Bipok » or « Tripok » dividers with 1/4 turn ball valve shutoffs** allow an easy and quick handling of the flow control, without almost any pressure loss. This range is available with several different couplings configurations (DSP, Storz, Guillemin, NST-NH,...).

Ball valve shutoffs with full waterway, 1/4 turn opening and low pressure loss.

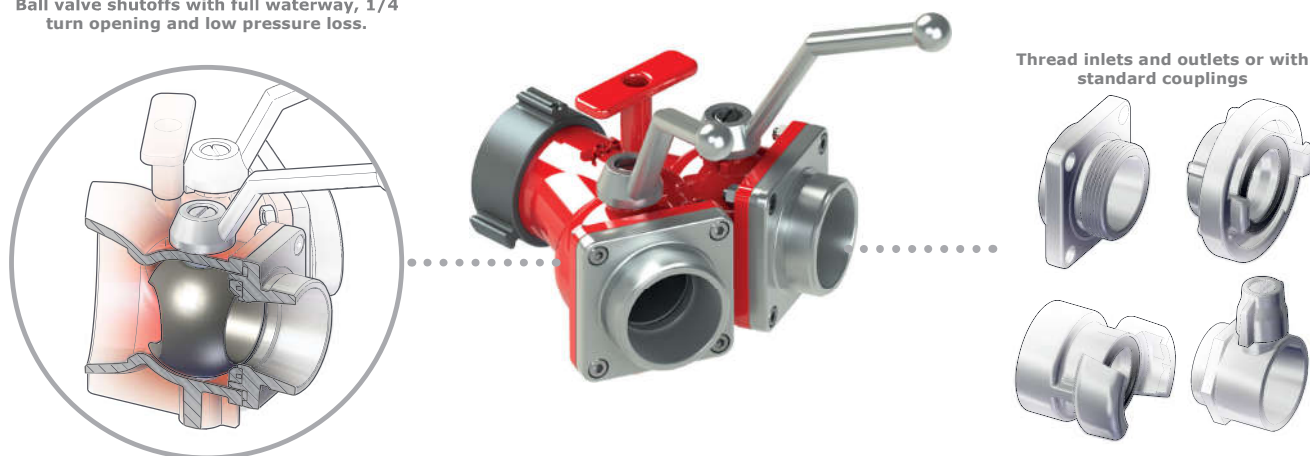

- **2 or 3-way dividers with flywheel valves** allow a precise control of the flow, avoiding water hammers and avoiding pressure loss in "maximum opening" position. This range is available with several different couplings configurations (DSP, Storz, Guillemin, NST-NH, etc...).

Dividers with flywheel valves for a progressive opening, avoiding water hammers.

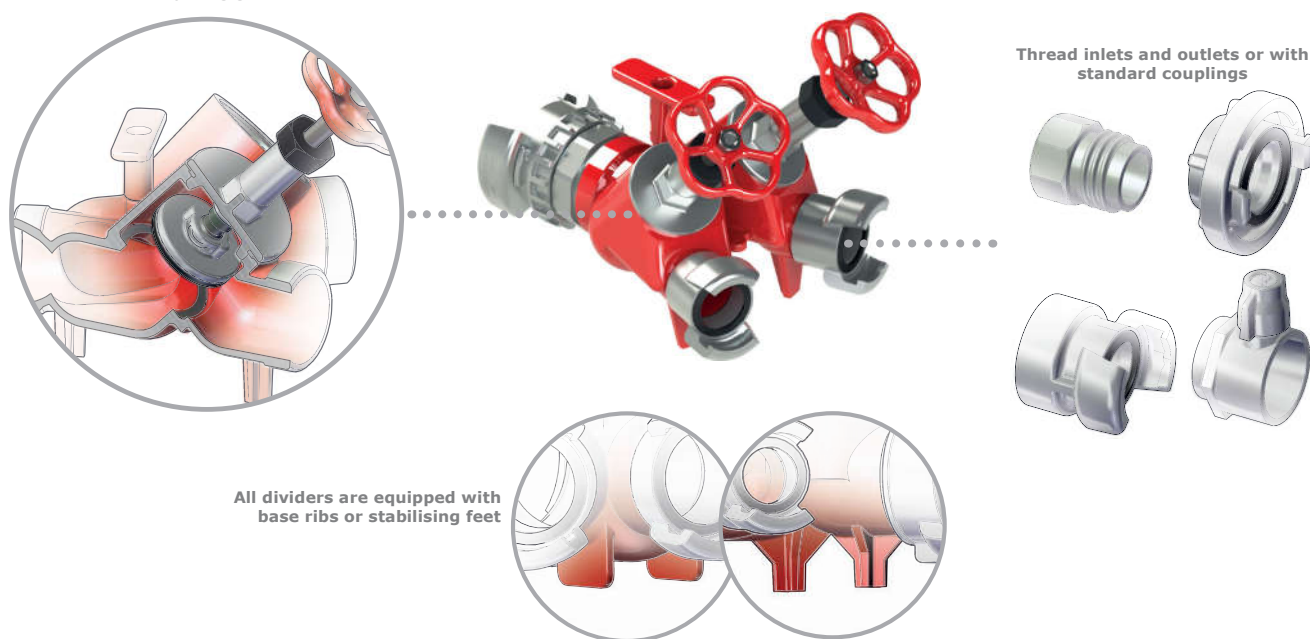

All dividers are equipped with base ribs or stabilising feet

It is possible to equip different diameters of dividers with a pressure gauge. This range of « POK » dividers offer a large range of diameters going from DN20 to DN250.

Dividers (2-way) without shutoff



Our range of dividers without shutoff are primarily made of heat treated aluminium alloy and red polyester coating. There is almost no pressure loss thanks to its full waterway. It is fitted with base ribs or stabilising feet.

It is equipped with one inlet and two outlets. A large number of in and outlet connections can be provided: threaded BSP or NST-NH, or standardised couplings.

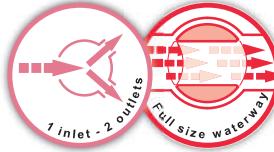

Maximum working pressure: PN16
Material: aluminium alloy
Coating: polyester coating
Body type: moulded

2-way dividers without shutoff - BSP threads



Inlet	Outlets	Dimensions (mm)	Weight (kg)	Ref.
1.5" BSP female	2x 1.5" BSP female	91 x 107 x 55	0,21	16569
2" BSP male	2x 2" BSP male	100 x 131 x 98	0,46	23536
2.5" BSP female	2x 1.5" BSP female	88 x 129 x 112	0,46	03256
2.5" BSP male	2x 2" BSP male	90 x 129 x 126	0,45	21205
2.5" BSP female	2x 2.5" BSP female	122 x 183 x 150	0,86	02355
4" BSP female	2x 2" BSP female	90 x 153 x 150	0,63	02759
4" BSP female	2x 2.5" BSP female	110 x 184 x 150	0,86	03255
4" BSP female	2x 4" BSP female	167 x 231 x 150	1,17	26421
6" BSP male	2x 4" BSP female	148 x 216 x 215	1,66	09136
6" BSP male	2x 6" BSP male	209 x 302 x 215	3,22	09135

2-way dividers without shutoff - DSP, AR or Guillemin couplings

Working pressure PN25 for dividers with inlet and outlet couplings with lock



Inlet	Outlets	Dimensions (mm)	Weight (kg)	Ref.
DSP DN40, with lock	2x DSP DN40, without lock	218 x 195 x 98	1,32	07470
DSP DN40, with lock	2x DSP DN40, with lock	242 x 242 x 98	1,63	07470.AV
DSP DN65, with lock	2x DSP DN40, without lock	209 x 194 x 126	1,56	07471
DSP DN65, with lock	2x DSP DN40, with lock	232 x 240 x 126	1,87	07471.AV
DSP DN65, with lock	2x DSP DN65, without lock	249 x 204 x 150	2,13	02374
DSP DN65, with lock	2x DSP DN65, with lock	284 x 231 x 150	2,50	02374.AV
AR DN100, with lock	2x DSP DN65, without lock	235 x 205 x 150	2,53	07472
AR DN100, with lock	2x DSP DN65, with lock	268 x 231 x 150	2,94	07472.AV
AR DN100, with lock	2x AR DN100, without lock	305 x 300 x 152	4,06	07473
AR DN100, with lock	2x AR DN100, with lock	325 x 316 x 152	4,61	07473.AV
SG DN150, with lock	2x AR DN100, without lock	268 x 275 x 215	8,61	09162
SG DN150, with lock	2x AR DN100, with lock	284 x 308 x 215	6,17	09162.AV
SG DN150, with lock	2x SG DN150, with lock	353 x 409 x 241	10,67	09160

2-way dividers without shutoff - Storz couplings

Storz swivel couplings and/or with catch on request



Inlet	Outlets	Dimensions (mm)	Weight (kg)	Ref.
Storz C/52, swivel	2x Storz C/52	172 x 209 x 98	1,40	07985
Storz B/75, swivel	2x Storz C/52	162 x 190 x 126	1,58	07986
Storz B/75, swivel	2x Storz B/75	211 x 259 x 150	2,50	07987
Storz A/110, swivel	2x Storz B/75	226 x 257 x 182	3,39	07988
Storz A/110, swivel	2x Storz A/110	314 x 384 x 182	6,60	07989
Storz DN100 / 4", swivel with catch	2x Storz DN100 / 4", swivel with catch	314 x 355 x 156	5,69	09921
Storz DN125 / 5", swivel with catch	2x Storz DN100 / 4", swivel with catch	311 x 355 x 196	6,14	09922
Storz DN150 / 6"	2x Storz A/110	273 x 357 x 215	7,11	07990
Storz DN150 / 6", with catch	2x Storz DN100 / 4", swivel with catch	257 x 326 x 215	6,27	09923
Storz DN150 / 6", with catch	2x Storz DN125 / 5", swivel with catch	269 x 349 x 215	7,18	09924
Storz DN150 / 6"	2x Storz DN150 / 6"	311 x 386 x 215	8,90	09158
Storz DN150 / 6", with catch	2x Storz DN150 / 6", with catch	305 x 386 x 215	8,91	13612

2-way dividers without shutoff - NST-NH or US Storz couplings



Inlet	Outlets	Dimensions (mm)	Weight (kg)	Ref.
1.5" NST-NH female	2x 1.5" NST-NH male	144 x 149 x 69	0,69	09911
2.5" NST-NH female	2x 1.5" NST-NH male	169 x 152 x 112	1,17	09912
2.5" NST-NH female	2x 2.5" NST-NH male	211 x 205 x 150	1,86	09913
3" NST-NH female	2x 2.5" NST-NH male	305 x 208 x 150	2,12	09914
4" NST-NH female	2x 3" NST-NH male	198 x 208 x 150	2,53	09915
Storz DN100 / 4", swivel with catch	2x 2.5" NST-NH male	225 x 209 x 156	2,78	09916
Storz DN100 / 4", swivel with catch	2x 3" NST-NH male	262 x 276 x 156	3,56	09918
Storz DN125 / 5", swivel with catch	2x 2.5" NST-NH male	224 x 209 x 196	3,24	09917
Storz DN125 / 5", swivel with catch	2x 3" NST-NH male	258 x 276 x 196	4,02	09919
Storz DN150 / 6", with catch	2x 3" NST-NH male	222 x 256 x 215	4,58	09920



Dividers (3-way) without shutoff



Our range of dividers without shutoff are primarily made of heat treated aluminium alloy and red polyester coating.

There is almost no pressure loss thanks to its full waterway. It is fitted with base ribs or stabilising feet.

It is equipped with one inlet and three outlets. A large number of in and outlet connections can be provided: threaded BSP or NST-NH, or standardised couplings.

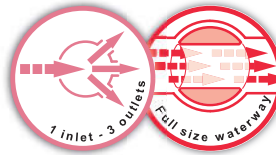

Maximum working pressure: PN16
Material: aluminium alloy
Coating: polyester coating
Body type: moulded

3-way dividers without shutoff - BSP threads



Inlet	Outlets	Dimensions (mm)	Weight (kg)	Ref.
4" BSP female	3x 2.5" BSP female	153 x 258 x 150	1,36	02315
4" BSP female	1x 4" BSP female 2x 2.5" BSP female	163 x 280 x 150	1,53	02314
4" BSP female	3x 4" BSP female	198 x 288 x 150	2,65	07043
6" BSP male	3x 4" BSP female	260 x 357 x 203	4,37	09137

3-way dividers without shutoff - DSP, AR or Guillemin couplings

Working pressure PN25 for dividers with inlet and outlet couplings with lock



Inlet	Outlets	Dimensions (mm)	Weight (kg)	Ref.
AR DN100, with lock	3x DSP DN65, without lock	285 x 313 x 150	3,43	07474
AR DN100, with lock	1x AR DN100, without lock 2x DSP DN65, without lock	305 x 335 x 150	9,97	07475
AR DN100, with lock	3x AR DN100, without lock	340 x 372 x 152	5,82	07476
AR DN100, with lock	3x AR DN100, with lock	362 x 411 x 152	6,63	07476.AV
SG DN150, with lock	3x AR DN100, without lock	414 x 441 x 223	9,04	09161

3-way dividers without shutoff - Storz couplings

Storz swivel couplings and/or with catch on request



Inlet	Outlets	Dimensions (mm)	Weight (kg)	Ref.
Storz A/110, swivel	3x Storz B/75	262 x 314 x 182	4,00	07991
Storz A/110, swivel	1x Storz A/110 2x Storz B/75	286 x 338 x 182	5,35	07992
Storz A/110, swivel	3x Storz A/110	347 x 437 x 182	9,40	07993
Storz DN150 / 6"	3x Storz A/110	353 x 424 x 223	9,15	09152
Storz DN100 / 4", with catch	3x Storz DN100 / 4", with catch	350 x 412 x 156	8,08	09929
Storz DN125 / 5", with catch	3x Storz DN100 / 4", with catch	346 x 412 x 196	8,54	09930
Storz DN150 / 6", with catch	3x Storz DN100 / 4", with catch	391 x 481 x 228	10,34	09931

3-way dividers without shutoff - NST-NH or US Storz couplings



Inlet	Outlet	Dimensions (mm)	Weight (kg)	Ref.
3" NST-NH female, swivel	3x 2.5" NST-NH male	256 x 310 x 150	3,52	09925
4" NST-NH female, swivel	3x 2.5" NST-NH male	247 x 311 x 150	3,36	09926
Storz DN100 / 4", with catch	3x 2.5" NST-NH male	273 x 311 x 156	3,61	09927
Storz DN125 / 5", with catch	3x 2.5" NST-NH male	270 x 311 x 196	4,06	09928

Our "Bipok" dividers are equipped with 2 ball valve shutoffs, one carrying handle and stabilising feet. There is almost no pressure loss thanks to its full waterway. A large number of in and outlet connections can be provided: threaded BSP or NST-NH, or standardised couplings. Primarily made of heat treated aluminium alloy and red polyester coating.



Maximum working pressure: PN16
Valve type: ball valve or butterfly valve
Operation: by lever or flywheel
Material: aluminium alloy
Coating: polyester coating
Body type: moulded

Options: inlet/outlet couplings, pressure gauge.

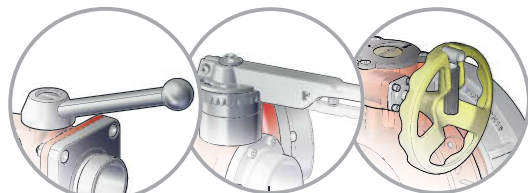

Depending on the outlet diameter of the waterway, handles are with or without indexed notches, and with or without unlocking levers, or with worm screw knobs for DN205 and DN250.

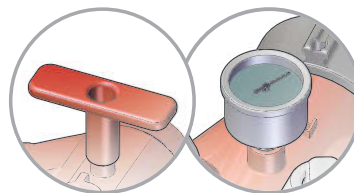

Depending on preferences, the dividers can be assembled with carrying handles or pressure gauges.

2-way dividers with ball or butterfly valves - BSP threads

8" and 10" comes with pressure regulating valve and pressure gauge



Inlet	Outlets	Optional pressure gauge	Dimensions (mm)	Weight (kg)	Ref.
1" BSP male	2x 1" BSP male	-	180 x 153 x 144	1,56	07406
1.5" BSP male	2x 1" BSP male	-	175 x 153 x 144	1,54	07407
2" BSP male	2x 1" BSP male	-	180 x 153 x 144	1,60	02758
2" BSP male	2x 2" BSP male	•	223 x 183 x 171	2,36	09672
2.5" BSP male	2x 1.5" BSP male	•	202 x 183 x 171	2,19	07415
2.5" BSP male	2x 2" BSP male	•	202 x 183 x 171	2,25	03316
2.5" BSP male	2x 2.5" BSP male	•	258 x 218 x 218	3,47	07416
3" BSP female	2x 3" BSP female	-	388 x 346 x 213	7,65	14067
4" BSP female	2x 2.5" BSP male	•	216 x 217 x 220	3,46	07417
4" BSP female	2x 4" BSP male	-	373 x 394 x 285	9,64	07418
6" BSP male	2x 4" BSP male	-	331 x 581 x 258	9,97	07419
6" BSP male	2x 6" BSP male	•	447 x 548 x 328	29,57	25002
8" BSP male	2x 8" BSP male	-	600 x 490 x 480	39,00	37021
10" BSP male	2x 10" BSP male	-	615 x 525 x 480	42,00	37023

2-way dividers with ball or butterfly valves - GFR, DSP, AR or Guillemin couplings

Working pressure PN25 for dividers with inlet and outlet couplings with lock



Inlet	Outlets	Optional pressure gauge	Dimensions (mm)	Weight (kg)	Ref.
GFR DN20 female	2x GFR DN20 male	-	212 x 153 x 144	1,71	09378
DSP DN40, with lock	2x GFR DN20 male	-	221 x 153 x 144	1,73	07410
DSP DN40, with lock	2x SG DN20, without lock	-	221 x 153 x 144	1,84	07411
DSP DN65, with lock	2x DSP DN40, without lock	•	268 x 183 x 171	2,81	03205
DSP DN65, with lock	2x DSP DN40, with lock	•	278 x 210 x 171	2,92	03205.AV
SG DN65, with lock	2x SG DN40, without lock	•	271 x 283 x 171	2,85	07412
DSP DN65, with lock	2x DSP DN65, without lock	•	324 x 230 x 218	4,56	07413
DSP DN65, with lock	2x DSP DN65, with lock	•	344 x 269 x 218	5,16	07413.AV
AR DN100, with lock	2x DSP DN65, without lock	•	299 x 230 x 220	5,16	07414
AR DN100, with lock	2x DSP DN65, with lock	•	318 x 268 x 220	5,74	07414.AV
AR DN100, with lock	2x AR DN100, without lock	-	456 x 394 x 285	12,03	09379
AR DN100, with lock	2x AR DN100, with lock	-	456 x 405 x 285	13,10	09379.AV
SG DN150, with lock	2x AR DN100, without lock	-	422 x 581 x 258	13,85	09163
SG DN150, with lock	2x SG DN150, with lock	•	542 x 558 x 328	37,07	09674

2-way dividers with ball or butterfly valves - Storz couplings

Storz swivel couplings and/or with catch on request, DN205 and DN250 comes with pressure regulating valve and pressure gauge



Inlet	Outlets	Optional pressure gauge	Dimensions (mm)	Weight (kg)	Ref.
Storz D/25	2x Storz D/25	-	208 x 164 x 144	1,82	09080
Storz C/52	2x Storz D/25	-	215 x 165 x 144	2,06	09081
Storz B/75	2x Storz C/52	•	240 x 215 x 171	3,16	09082
Storz B/75	2x Storz B/75	•	295 x 277 x 218	4,90	09083
Storz A/110, swivel	2x Storz B/75	•	281 x 277 x 236	5,79	09084
Storz A/110, swivel	2x Storz A/110	-	413 x 427 x 285	13,44	09085
Storz DN150 / 6"	2x Storz A/110	-	385 x 581 x 258	14,41	09086
Storz DN205 / 8"	2x Storz DN205 / 8"	-	582 x 673 x 476	52,80	37009
Storz DN250 / 10"	2x Storz DN250 / 10"	-		57,00	37006

Dividers (2-way) with ball valves "BIPOK"



2-way dividers with ball or butterfly valves - US Storz or NST-NH couplings

Storz swivel couplings and/or with catch on request



Inlet	Outlets	Optional pressure gauge	Dimensions (mm)	Weight (kg)	Ref.
Storz DN100 / 4", swivel	2x 2.5" NST-NH male	•	292 x 217 x 223	4,82	09898
Storz DN100 / 4", swivel	2x 3" NST-NH male	•	292 x 230 x 223	5,20	09900
Storz DN100 / 4", swivel	2x Storz DN100 / 4"	-	449 x 403 x 285	13,66	09903
Storz DN125 / 5", swivel with catch	2x 2.5" NST-NH male	•	289 x 217 x 243	5,30	09899
Storz DN125 / 5", swivel with catch	2x 3" NST-NH male	•	289 x 230 x 243	5,68	09901
Storz DN125 / 5", swivel with catch	2x Storz DN100 / 4"	-	446 x 403 x 288	13,14	09904
Storz DN150 / 6", with catch	2x 3" NST-NH male	-	385 x 581 x 258	14,23	09902
Storz DN150 / 6"	2x Storz DN100 / 4"	-	385 x 581 x 258	13,54	09905
Storz DN150 / 6"	2x Storz DN150 / 6"	•	501 x 566 x 328	35,70	25020

2-way dividers with ball valves - NST-NH couplings



Inlet	Outlets	Optional pressure gauge	Dimensions (mm)	Weight (kg)	Ref.
1" NST-NH female	2x 1" NST-NH male	-	200 x 153 x 144	1,68	02769
1.5" NST-NH female	2x 1" NST-NH male	-	198 x 153 x 144	1,69	02770
1.5" NST-NH female	2x 1.5" NST-NH male	•	231 x 183 x 171	2,39	02171
2.5" NST-NH female	2x 1.5" NST-NH male	•	226 x 183 x 171	2,41	09866
2.5" NST-NH female	2x 2.5" NST-NH male	•	281 x 217 x 218	3,46	02772
3" NST-NH female	2x 2.5" NST-NH male	•	268 x 217 x 220	4,35	09893
4" NST-NH female	2x 2.5" NST-NH male	•	267 x 217 x 229	4,59	02768

2-way dividers with ball valves - with pressure gauge



Maximum working pressure: PN16
 Valve type: ball valve
 Operation: by lever
 Material: aluminium alloy
 Coating: polyester coating
 Body type: moulded
 Pressure gauge: YES

Options: couplings inlet/outlet.

These "Bipok" dividers are equipped with ball valve shutoffs, one pressure gauge, and stabilising feet.
 There is almost no pressure loss thanks to its full waterway. A large number of in and outlet connections can be provided: threaded BSP or NST-NH, or standardised couplings.

Inlet	Outlets	Dimensions (mm)	Weight (kg)	Ref.
2.5" NST-NH female	2x 1.5" NST-NH male	226 x 183 x 171	2,60	13300
2.5" NST-NH female	2x 2.5" NST-NH male	281 x 217 x 218	2,90	13304

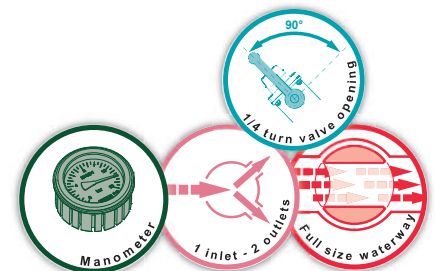

2-way dividers with ball valves - with flush valve



Maximum working pressure: PN16
 Valve type: ball valve
 Operation: by lever
 Material: aluminium alloy
 Coating: polyester coating
 Body type: moulded
 Flush: YES

Options: couplings inlet/outlet.

These "Bipok" dividers are equipped with ball valve shutoffs, a flush valve on each outlet and stabilising feet.
 There is almost no pressure loss thanks to its full waterway. A large number of in and outlet connections can be provided: threaded BSP or NST-NH, or standardised couplings.

Inlet	Outlets	Dimensions (mm)	Weight (kg)	Ref.
DSP DN50, with lock	2x DSP DN50, without lock	226 x 183 x 171	5,22	16008

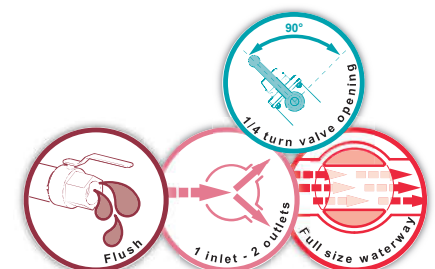

2-way dividers with ball valves - US Navy "BIPOK"



This divider equips
US Navy
Homologation nato
4210-00-255-0234

Maximum working pressure: PN16
Valve type: ball valve
Operation: by lever
Material: bronze and stainless steel
Body type: moulded

Options: couplings inlet/outlet.

Our divider « US NAVY Bipok » is made of bronze.
It is equipped with two ball valve shutoffs and stabilising feet. There is almost no pressure loss thanks to its full waterway.
It is equipped with one inlet female threaded 2.5" NST-NH and two outlets male threaded 1.5" NPSH. This divider equips the US Navy: 481 units ordered in 2007.

Inlet	Outlets	Dimensions (mm)	Weight (kg)	Ref.
2.5" NST-NH female	2x 1.5" NSPH male	184 x 181 x 125	3,35	17030

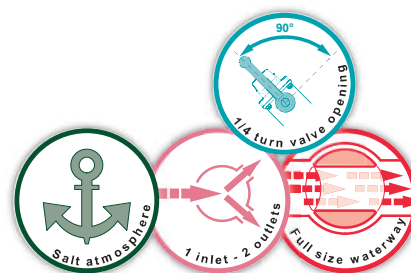

Dividers (3-way) with ball valves "TRIPOK"



Our Tripok are made to split one supply into several hoses supply through its three outlets.

It is equipped with three ball valve shutoffs, one carrying handle and stabilising feet. There is almost no pressure loss thanks to its full waterway. A large number of in and outlet connections can be provided: threaded BSP or NST-NH, or standardised couplings.

Primarily made of heat treated aluminium alloy and red polyester coating.



Maximum working pressure: PN16
Valve type: ball valve or butterfly valve
Operation: by lever or flywheel
Material: aluminium alloy
Coating: polyester coating
Body type: moulded

Options: inlet/outlet couplings, pressure gauge, pressure regulation.

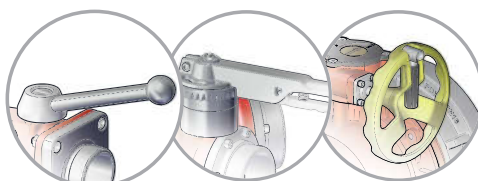

Depending on the outlet diameter of the waterway, handle are with or without indexed notches, and with or without unlocking levers, or with worm screw knobs for DN205 and DN250.

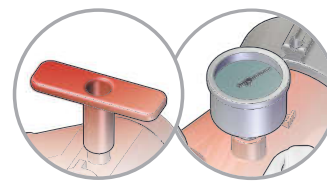

Depending on preferences, the dividers can be assembled with carrying handles or pressure gauges.

3-way dividers with ball or butterfly valves - BSP threads



Inlet	Outlets	Optional pressure gauge	Dimensions (mm)	Weight (kg)	Ref.
2" BSP male	1x 2" BSP male 2x 1" BSP male	•	216 x 274 x 158	2,67	07424
2.5" BSP male	3x 2" BSP male	•	290 x 368 x 218	4,01	07426
2.5" BSP male	1x 2.5" BSP male 2x 2" BSP male	•	290 x 368 x 218	4,05	07425
4" BSP female	3x 2.5" BSP male	•	261 x 357 x 219	5,09	07427
4" BSP female	1x 4" BSP male 2x 2.5" BSP male	•	412 x 406 x 282	8,31	07428
4" BSP female	3x 4" BSP male	-	506 x 772 x 230	15,12	07429
6" BSP male	3x 4" BSP male	-	575 x 852 x 270	16,88	09675
6" BSP male	1x 6" BSP male 2x 3" BSP male	•	499 x 513 x 328	21,30	24743

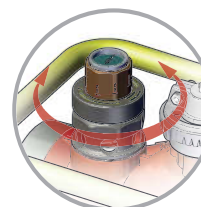

Adjustable pressure valve regulator on the divider big diameter reference 24743

3-way dividers with ball or butterfly valves - GFR, DSP, AR or Guillemin couplings

Working pressure PN25 for dividers with inlet and outlet couplings with lock



Inlet	Outlets	Optional pressure gauge	Dimensions (mm)	Weight (kg)	Ref.
DSP DN40, with lock	1x DSP DN40 2x GFR DN20 male	•	255 x 274 x 158	2,88	02691
DSP DN40, with lock	1x DSP DN40, with lock 2x GFR DN20 male	•	304 x 274 x 158	3,07	02691.AV
DSP DN40, with lock	1x DSP DN40, 2x SG DN20	•	255 x 274 x 158	2,99	03199
DSP DN65, with lock	3x DSP DN40	•	336 x 368 x 218	4,70	07421
DSP DN65, with lock	3x DSP DN40, with lock	•	339 x 403 x 218	5,46	07421.AV
DSP DN65, with lock	1x DSP DN65, 2x DSP DN40	•	336 x 368 x 218	4,85	07420
DSP DN65, with lock	1x DSP DN65, with lock 2x DSP DN40, with lock	•	345 x 403 x 218	5,76	07420.AV
AR DN100, with lock	3x DSP DN65	•	343 x 357 x 219	7,13	07422
AR DN100, with lock	3x DSP DN65, with lock	•	354 x 426 x 219	8,00	07422.AV
AR DN100, with lock	1x AR DN100, 2x DSP DN65	•	497 x 405 x 282	10,69	07423
AR DN100, with lock	1x AR DN100, with lock, 2x DSP DN65, with lock	•	497 x 475 x 282	11,81	07423.AV
AR DN100, with lock	3x AR DN100, with lock	-	588 x 772 x 230	19,80	07448
SG DN150, with lock	3x AR DN100	-	668 x 852 x 270	23,06	09164
SG DN150, with lock	1x SG DN150, with lock 2x AR DN100, with lock	•	560 x 675 x 328	28,90	25022

3-way dividers with ball or butterfly valves - Storz couplings

Storz swivel couplings and/or with catch on request



Inlet	Outlets	Optional pressure gauge	Dimensions (mm)	Weight (kg)	Ref.
Storz C/52	1x Storz C/52 2x Storz D/25	•	251 x 274 x 158	3,42	09073
Storz B/75	3x Storz C/52	•	327 x 368 x 218	5,31	09075
Storz B/75	1x Storz B/75 2x Storz C/52	•	327 x 368 x 218	5,51	09074
Storz A/110, swivel	3x Storz B/75	•	326 x 383 x 235	7,85	09076
Storz A/110, swivel	1x Storz A/110 2x Storz B/75	•	479 x 432 x 282	11,91	09077
Storz A/110, swivel	3x Storz A/110	-	571 x 772 x 241	20,39	09078
Storz DN150 / 6"	3x Storz A/110	-	629 x 852 x 270	22,60	09166
Storz DN150 / 6"	1x Storz DN150 / 6" 2x Storz B/75	•	528 x 544 x 328	25,77	25021

3-way dividers with ball or butterfly valves - US Storz or NST-NH couplings

Storz swivel couplings and/or with catch on request



Inlet	Outlets	Optional pressure gauge	Dimensions (mm)	Weight (kg)	Ref.
Storz DN100 / 4", swivel with catch	3x 2.5" NST-NH male	•	337 x 357 x 222	6,46	09906
Storz DN100 / 4", swivel with catch	3x Storz DN100 / 4"	-	582 x 772 x 230	19,00	09908
Storz DN125 / 5", swivel with catch	3x 2.5" NST-NH male	•	334 x 357 x 242	6,91	09907
Storz DN125 / 5", swivel with catch	3x Storz DN100 / 4"	-	579 x 772 x 250	19,46	09909
Storz DN150 / 6", with catch	3x Storz DN100 / 4"	-	629 x 772 x 270	21,30	09910

3-way dividers with ball valves - NST-NH couplings



Inlet	Outlets	Optional pressure gauge	Dimensions (mm)	Weight (kg)	Ref.
1.5" NST-NH female	1x 1.5" NST-NH male 2x 1" NST-NH male	•	233 x 274 x 158	2,76	08377
2.5" NST-NH female	1x 2.5" NST-NH male 2x 1.5" NST-NH male	•	307 x 368 x 218	4,18	09894
2.5" NST-NH female	3x 2.5" NST-NH male	•	361 x 357 x 219	5,87	09895
3" NST-NH female	3x 2.5" NST-NH male	•	320 x 357 x 219	6,38	09896
4" NST-NH female	3x 2.5" NST-NH male	•	313 x 357 x 219	6,24	09897

Double inlet with clappered siamese



Maximum working pressure: PN16
 Valve type: ball valve
 Operation: by lever
 Material: aluminium alloy
 Coating: polyester coating
 Body type: moulded
 Options: couplings inlet/outlet.

Divider with three outlets with 1/4 turn ball valve shutoffs with an integrated two inlets clappered siamese. This compact divider allows multiple possibilities of use: for example, concerning the supply through its integrated clappered siamese. The three outlets with 1/4 turn ball valve shutoffs offer a quick handling and full waterway. It offers several possibilities of connections: DSP/AR couplings, symmetrical couplings, Storz couplings.

Inlet	Outlets	Handle or pressure gauge	Dimensions (mm)	Weight (kg)	Ref.
2x 2.5" BSP male	1x 2.5" BSP male 2x 2" BSP male	Yes	368 x 371 x 220	4,27	07575
2x 2.5" BSP male	3x 2.5" BSP male	Yes	368 x 371 x 220	4,36	08378
2x Storz B/75	1x Storz B/75 2x Storz C/52	Yes	404 x 371 x 220	6,15	09079

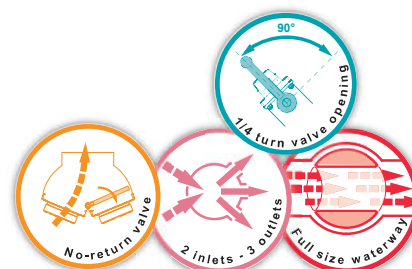

Dividers (4-way) with ball valves "QUADRIPOK"



4-way dividers with ball valves, with transport trolley

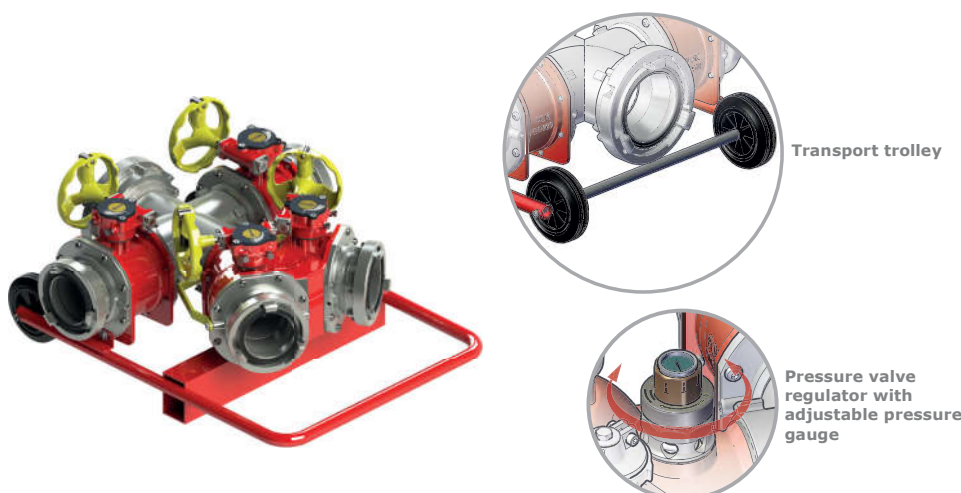

Maximum working pressure: PN16

Valve type: ball valve

Operation: by handwheel

Material: aluminium alloy

Coating: polyester coating

Body type: moulded

Pressure gauge: YES

Options: inlet/outlet couplings, pressure gauge, pressure regulation.

Our divider "Quadripok" has four outlets equipped with ball valve shutoffs. It allows to split one supply into several outlets. There is almost no pressure loss thanks to its full waterway. It is equipped with stabilising feet and a pressure gauge. It is delivered with a transport trolley which allows one to move without any effort. A large number of in and outlet connections can be provided: threaded BSP or NST-NH, or standardised couplings.

Inlet	Outlet	Dimensions (mm)	Weight (kg)	Ref.
6" BSP female	4x 6" BSP male	1044 x 780 x 445	72,33	37055
Storz DN200 / 8"	4x Storz DN150 / 6"	1044 x 888 x 445	86,25	27048

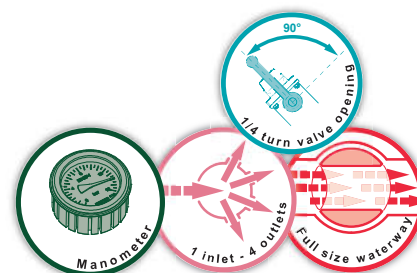

4-way dividers with ball valves, with torque reducers



Maximum working pressure: PN16

Valve type: ball valve

Operation: by flywheel

Material: aluminium alloy

Coating: polyester coating

Body type: moulded

Pressure gauge: YES

Options: inlet/outlet couplings, pressure gauge, pressure regulation.

Our divider "Quadripok" has four outlets equipped with ball valve shutoffs having the particularity to have a progressive opening. This POK innovation offers all the advantages of a 1/4 turn ball valve divider, with low pressure loss, and also the advantages of a divider with flywheel valves with its progressive opening, avoiding water hammers. There is almost no pressure loss thanks to its full waterway. It is equipped with two carrying handles, stabilising feet and a pressure gauge. A large number of in and outlet connections can be provided: threaded BSP or NST-NH, or standardised couplings.

Inlet	Outlet	Dimensions (mm)	Weight (kg)	Ref.
6" BSP male	4x 3" BSP male	334 x 490 x 258	15,05	28752
GOST DN150	4x GOST DN80	366 x 494 x 258	18,30	28766

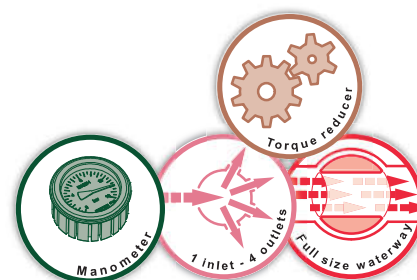

5-way dividers with ball or butterfly valves



Our divider "Pentapok" has five outlets equipped with ball valve shutoffs and a butterfly valve. It allows to split one supply into five.

There is almost no pressure loss thanks to its full waterway. It is equipped with stabilising feet and a pressure gauge.

A large number of in and outlet connections can be provided: threaded BSP or NST-NH, or standardised couplings.

Maximum working pressure: PN16
Valve type: ball valve or butterfly valve
Operation: by lever
Material: aluminium alloy
Coating: polyester coating
Body type: moulded
Pressure gauge: YES

Options: inlet/outlet couplings, pressure gauge, pressure regulation.

Inlet	Outlets	Dimensions (mm)	Weight (kg)	Ref.
4" BSP female	1x 4" BSP male, 4x 2.5" BSP male	484 x 607 x 293	13,12	18467
4" NST-NH female	1x 4" NST-NH male, 4x 2.5" NST-NH male	538 x 607 x 293	15,04	18463
AR DN100, with lock	1x AR DN100, without lock 4x DSP DN65, without lock	569 x 607 x 293	16,18	18465
Storz DN100 / 4", swivel with catch	4x Storz DN100 / 4", 4x 2.5" NST-NH male	563 x 607 x 293	15,38	18464
Storz A/110, with catch	1x Storz A/110, 4x Storz B/75	525 x 607 x 293	17,40	14689
Storz A/110, with catch	1x Storz A/110, with catch 4x Storz B/75, with catch	574 x 607 x 293	18,08	14689.AV
Storz DN125 / 5", swivel with catch	1x Storz DN125 / 5", 4x Storz DN65 / 2.5"	560 x 607 x 293	21,06	18468
SG DN150, with lock	1x AR DN100, without lock 4x DSP DN65, without lock	670 x 607 x 293	19,07	18466

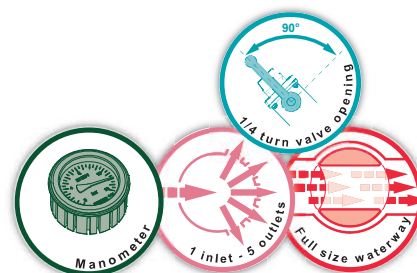

5-way dividers with ball valves, with one torque reducer



This divider "Pentapok" has five outlets equipped with ball valve shutoffs and a butterfly valve. The middle outlet is equipped with a torque reducer for a progressive opening.

It allows to split one supply into five. There is almost no pressure loss thanks to its full waterway. It is equipped with stabilising feet, a pressure gauge and pressure regulating valve.

A large number of in and outlet connections can be provided: threaded BSP or NST-NH, or standardised couplings.

Maximum working pressure: PN16
Valve type: ball valve or butterfly valve
Operation: by lever and flywheel
Material: aluminium alloy
Coating: polyester coating
Body type: moulded
Pressure gauge: YES

Options: inlet/outlet couplings, pressure gauge, pressure regulation.

Inlet	Outlets	Dimensions (mm)	Weight (kg)	Ref.
8" BSP male	1x 8" BSP male 4x 2.5" BSP male	670 x 505 x 480	33,00	37077
8" BSP male	1x 8" BSP male 4x 3" BSP male	670 x 505 x 480	34,00	37322
10" BSP male	1x 10" BSP male 4x 2.5" BSP male	670 x 535 x 480	37,00	37323
Storz DN205	1x Storz DN205 4x Storz B/75	670 x 575 x 480	44,00	37324
Storz DN250	1x Storz DN250 4x Storz B/75	670 x 645 x 480	49,00	37325

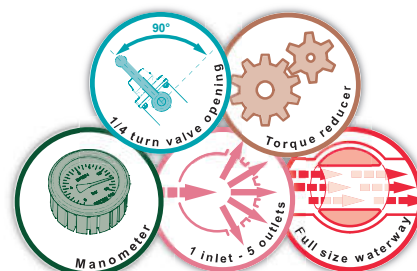

Dividers (2-way) with flywheel valves



These dividers have two outlets fitted with flywheel valves for a progressive opening, avoiding water hammers. They are primarily made of heat treated aluminium alloy and red polyester coating. They are equipped with a carrying handle (depending on the model) and stabilising feet.

A large number of in and outlet connections can be provided: threaded BSP or NST-NH, or standardised couplings.

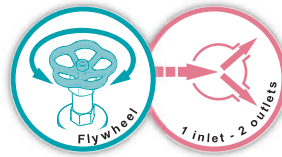

Maximum working pressure: PN16

Valve type: flywheel valve

Operation: by flywheel

Material: aluminium alloy

Coating: polyester coating

Body type: moulded

Options: couplings inlet/outlet.

2-way dividers with flywheel valves - BSP threads



Inlet	Outlets	Standard valves	Compact valves	Dimensions (mm)	Weight (kg)	Ref.
1.5" BSP female	2x 1" BSP male	•		153 x 180 x 157	1,03	29440
1.5" BSP male	2x 1.5" BSP male	•		255 x 234 x 236	2,21	16244
1.5" BSP male	2x 1.5" BSP male		•		1,99	40677
2.5" BSP male	2x 1.5" BSP male	•		260 x 240 x 240	2,13	07444
2.5" BSP male	2x 1.5" BSP male		•		1,91	40680
2.5" BSP male	2x 2" BSP male	•		265 x 260 x 235	2,33	07447
2.5" BSP male	2x 2" BSP male		•		2,11	40683
2.5" BSP male	2x 2.5" BSP male	•		275 x 290 x 260	3,10	07445
2.5" BSP male	2x 2.5" BSP male		•		2,98	40686
4" BSP female	2x 2.5" BSP male	•		265 x 260 x 285	3,72	07446
4" BSP female	2x 2.5" BSP male		•		3,60	40689
4" BSP female	2x 2" BSP female	•		241 x 272 x 262	2,89	32779
4" BSP female	2x 2" BSP female		•		2,67	40692

2-way dividers with flywheel valves - GFR, DSP, AR or Guillemin couplings

The divider 07440 equips the French Navy

Working pressure PN25 for dividers with inlet and outlet couplings with lock

Approved by the French Navy
N°6596/50 STCM



Inlet	Outlets	Standard valves	Compact valves	Dimensions (mm)	Weight (kg)	Ref.
DSP DN40, with lock	2x GFR DN20 male	•		219 x 180 x 157	1,37	24498
DSP DN40, with lock	2x DSP DN40	•		360 x 240 x 240	2,70	16444
DSP DN40, with lock	2x DSP DN40		•		2,48	40695
DSP DN40, with lock	2x DSP DN40, with lock	•		358 x 234 x 236	3,11	16444.AV
DSP DN40, with lock	2x DSP DN40, with lock		•		2,89	40698
DSP DN65, with lock	2x DSP DN40	•		300 x 234 x 236	2,85	07440
DSP DN65, with lock	2x DSP DN40		•		2,63	40701
DSP DN65, with lock	2x DSP DN40, with lock	•		322 x 234 x 236	3,11	07440.AV
DSP DN65, with lock	2x DSP DN40, with lock		•		2,89	40704
DSP DN65, with lock	2x DSP DN65	•		362 x 290 x 260	4,36	07443
DSP DN65, with lock	2x DSP DN65		•		4,24	40707
DSP DN65, with lock	2x DSP DN65, with lock	•		396 x 307 x 260	5,01	07443.AV
DSP DN65, with lock	2x DSP DN65, with lock		•		4,89	40710
AR DN100, with lock	2x DSP DN65	•		345 x 260 x 285	5,36	07441
AR DN100, with lock	2x DSP DN65		•		5,24	40713
AR DN100, with lock	2x DSP DN65, with lock	•		379 x 267 x 285	5,96	07441.AV
AR DN100, with lock	2x DSP DN65, with lock		•		5,84	40716

2-way dividers with flywheel valves - Storz couplings

Storz swivel couplings and/or with catch on request



Inlet	Outlets	Standard valves	Compact valves	Dimensions (mm)	Weight (kg)	Ref.
Storz DN45, swivel	2x Storz D25	•		191 x 180 x 157	1,47	23416
Storz B/75	2x Storz C/52	•		280 x 265 x 235	3,30	09070
Storz B/75	2x Storz C/52		•		3,08	40719
Storz B/75	2x Storz B/75	•		315 x 315 x 260	4,43	09071
Storz B/75	2x Storz B/75		•		4,31	40722
Storz A/110	2x Storz B/75	•		320 x 300 x 300	5,94	09072
Storz A/110	2x Storz B/75		•		5,82	40725

2-way dividers with flywheel valves - Instantaneous couplings



Inlet	Outlets	Standard valves	Compact valves	Dimensions (mm)	Weight (kg)	Ref.
Instantaneous 2.5" male	2x Instantaneous 2.5" female	•		332 x 338 x 260	4,71	15562
Instantaneous 2.5" male	2x Instantaneous 2.5" female		•		4,59	40728



Dividers (3-way) with flywheel valves



It has three outlets fitted with flywheel valves for a progressive opening and closure, avoiding any water hammer. It is made of primary aluminium alloy heat-treated and red polyester coated. It is equipped with a carrying handle (depending on the model) and stabilising feet. A large number of in and outlet connections can be provided: threaded BSP or NST-NH, or standardised couplings.

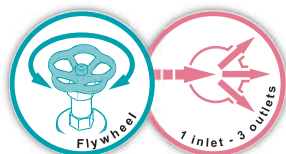

Maximum working pressure: PN16
Valve type: flywheel valve
Operation: by flywheel
Material: aluminium alloy
Coating: polyester coating
Body type: moulded

Options: couplings inlet/outlet.

3-way dividers with flywheel valves - BSP threads



Inlet	Outlets	Standard valves	Compact valves	Dimensions (mm)	Weight (kg)	Ref.
2" BSP male	1x 2" BSP male 2x 1" BSP male	•		240 x 266 x 222	2,30	31433
2" BSP male	1x 2" BSP male 2x 1" BSP male		•	258	2,19	40731
2.5" BSP male	1x 2.5" BSP male 2x 2" BSP male	•		300 x 410 x 260	4,26	07452
2.5" BSP male	1x 2.5" BSP male 2x 2" BSP male		•	258 x 343 x 215	3,92	39700
4" BSP male	3x 2.5" BSP male	•		325 x 460 x 250	5,20	07453
4" BSP male	3x 2.5" BSP male		•		5,02	40734
4" BSP male	1x 4" BSP male 2x 2" BSP male	•		459 x 256 x 277	7,30	32403*

*Butterfly valve and torque reducer on the middle outlet.

3-way dividers with flywheel valves - GFR, DSP, AR or Guillemin couplings

The divider 07450 equips the French Navy

Working pressure PN25 for dividers with inlet and outlet couplings with lock

Approved by the French Navy
 N°6596/49 STCM



Inlet	Outlets	Standard valves	Compact valves	Dimensions (mm)	Weight (kg)	Ref.
DSP DN40, with lock	1x DSP DN40, 2x GFR DN20 male	•		295 x 272 x 222	2,61	31430
DSP DN40, with lock	1x DSP DN40, 2x GFR DN20 male		•		2,50	40737
DSP DN65, with lock	3x DSP DN40	•		420 x 410 x 260	5,78	16183
DSP DN65, with lock	3x DSP DN40		•		5,45	40740
DSP DN65, with lock	3x DSP DN40, with lock	•		450 x 446 x 260	6,24	16183.AV
DSP DN65, with lock	3x DSP DN40, with lock		•		5,91	40743
DSP DN65, with lock	1x DSP DN65, 2x DSP DN40	•		400 x 410 x 260	5,68	07451
DSP DN65, with lock	1x DSP DN65, 2x DSP DN40		•		5,34	40611
DSP DN65, with lock	1x DSP DN65, with lock 2x DSP DN40, with lock	•		419 x 446 x 260	6,32	07451.AV
DSP DN65, with lock	1x DSP DN65, with lock 2x DSP DN40, with lock		•		5,98	40746
AR DN100, with lock	3x DSP DN65	•		420 x 470 x 260	7,05	07450
AR DN100, with lock	3x DSP DN65		•		6,87	40749
AR DN100, with lock	3x DSP DN65, with lock	•				07450.AV
AR DN100, with lock	3x DSP DN65, with lock		•			40752
AR DN100, with lock	1x AR DN100, with lock 2x DSP DN50, with lock	•		470 x 391 x 277	9,93	32191*

*Butterfly valve and torque reducer on the middle outlet.

3-way dividers with flywheel valves - Storz couplings

Storz swivel couplings and/or with catch on request



**In compliance with
DIN 14 345 - BV**

TÜV certificate number
PVR 13/02



Inlet	Outlets	Standard valves	Compact valves	Dimensions (mm)	Weight (kg)	Ref.
Storz C/52	1x Storz C/52 2x Storz D/25	•		277 x 276 x 222	3,04	31427
Storz C/52	1x Storz C/52 2x Storz D/25		•		2,93	40755
Storz B/75	3x Storz C/52	•		350 x 410 x 260	5,74	09068
Storz B/75	3x Storz C/52		•		5,41	40758
Storz B/75	1x Storz B/75 2x Storz C/52	•		340 x 410 x 260	5,71	09067
Storz B/75	1x Storz B/75 2x Storz C/52		•		5,37	40761
Storz A/110	3x Storz B/75	•		350 x 480 x 265	7,50	09069
Storz A/110	3x Storz B/75		•		7,32	40764
Storz A/110	1x Storz A/110 2x Storz C/52	•		458 x 334 x 279	10,56	37481*

*Butterfly valve and torque reducer on the middle outlet.

3-way dividers with flywheel valves - GFR, DSP, AR or Guillemin couplings - non-return valve

Working pressure PN25 for dividers with inlet and outlet couplings with lock



Maximum working pressure: PN16
Valve type: flywheel valve
Operation: by flywheel
Material: aluminium alloy
Coating: polyester coating
Body type: moulded
Lift handle: YES

This range of divider with flywheel valves is made of aluminium alloy with removable valve head for an easier maintenance.

This divider has been designed to avoid as much pressure loss as possible and is equipped with a non-return valve.

Our dividers have a carrying handle and stabilising feet.



Inlet	Outlets	Standard valves	Compact valves	Dimensions (mm)	Weight (kg)	Ref.
2" BSP male	1x 2" BSP male 2x 1" BSP male	•		250 x 266 x 222	2,34	37049
2" BSP male	1x 2" BSP male 2x 1" BSP male		•			40767
DSP DN40, with lock	1x DSP DN40, with lock 2x GFR DN20 male	•		296 x 266 x 235	2,74	34289
DSP DN40, with lock	1x DSP DN40, with lock 2x GFR DN20 male		•			40770
DSP DN40, with lock	1x DSP DN40, with lock 2x SG DN20	•		296 x 290 x 235	2,95	33609
DSP DN40, with lock	1x DSP DN40, with lock 2x SG DN20		•			40773

All our range of dividers have removable and interchangeable parts: wheels Ø50, Ø80 and Ø100 with square for valve head, complete valve heads Ø54 and Ø70, handles in aluminium alloy, stainless steel or composite material.

All our dividers with flywheel can be equipped and supplied with DIN shutoffs valves which, when opened, offer an integral passage, or compact shutoffs valves offering smaller dimensions.

Valve heads made of aluminium



Thread	Valve diameter	Norms	Dimensions (mm)	Weight (kg)	Ref.
1" BSP male	30		Ø80 x 107	0,20	23421
2" BSP male	54	DIN 14 345-C	Ø100 x 185	0,50	00796
2.5" BSP male	70	DIN 14 345-B	Ø100 x 212	0,63	00797

Compact valve heads made of aluminium



Thread	Valve diameter	Norms	Dimensions (mm)	Weight (kg)	Ref.
2" BSP male	54	DIN 14 345-C	Ø80 x 139	0,39	39697
2.5" BSP male	70	DIN 14 345-B	Ø100 x 152	0,57	39704

Valve heads, non-return valve and stem in bronze



Thread	Valve diameter	Dimensions (mm)	Weight (kg)	Ref.
2" BSP male	54	Ø100 x 188	0,88	35537
2.5" BSP male	70	Ø100 x 212	1,16	35528

Wheels with square



Wheel Ø (mm)	Square dimensions (mm)	Norms	Dimensions (mm)	Weight (kg)	Ref.
50	8	DIN 390	Ø50 x 18	0,03	03344
80	11	DIN 390	Ø80 x 22	0,07	03331
80	12	NF S61-758	Ø80 x 22	0,07	03332
100	11	DIN 390	Ø100 x 25	0,11	03322
100	12	NF S61-758	Ø100 x 25	0,11	03334

Operating handle - short model

for DN25 ball valve shutoff



Dimensions (mm)	Weight (kg)	Ref.
115 x 42 x 55	0,11	02402

Operating handle - long model

for DN40 and DN65 ball valve shutoffs



Dimensions (mm)	Weight (kg)	Ref.
158 x 42 x 71	0,13	02401

Operating long handle

for DN65 ball valve shutoff



Dimensions (mm)	Weight (kg)	Ref.
172 x 42 x 129	0,16	02861

Operating handle for US Navy "BIPOK"



Dimensions (mm)	Weight (kg)	Material	Ref.
138 x 45 x 38	0,26	Stainless steel	17038
138 x 45 x 38	0,05	Composite	30969

Carrying handle for divider



Dimensions (mm)	Weight (kg)	Ref.
90 x 28 x 50	0,07	03170

Repair kit for divider

The repair kit includes inlet and outlet couplings, gaskets, handle for ball valve and screws

Description	Ref.
Kit for divider "BIPOK" 1/4 turn ball - 1x DSP DN40 / 2x GFR DN20 male	01690
Kit for divider "BIPOK" 1/4 turn ball - 1x DSP DN65 / 2x DSP DN40	01691
Kit for divider "BIPOK" 1/4 turn ball - 1x AR DN100 / 2x DSP DN65	01693
Kit for divider "BIPOK" 1/4 turn ball - 1x AR DN100 / 2x AR DN100	01694
Kit for divider "TRIPOK" 1/4 turn ball - 1x DSP DN40 / 1x DSP DN40 - 2x GFR DN20 male	01695
Kit for divider "TRIPOK" 1/4 turn ball - 1x DSP DN65 / 1x DSP DN65 - 2x DSP DN40	01697
Kit for divider "TRIPOK" 1/4 turn ball - 1x DSP DN65 / 3x DSP DN40	01698
Kit for divider "TRIPOK" 1/4 turn ball - 1x AR DN100 / 1x AR DN100 - 2x DSP DN65	01699
Kit for divider "TRIPOK" 1/4 turn ball - 1x AR DN100 / 3x DSP DN65	01686



The "STANDROHRE" are standpipes made of aluminium alloy allowing to connect to the local underground water network. They are available in DN50 and DN80, with one or two outlets, with or without flywheel valves, with water meter, etc. Nota: The DN50 is specific for the County of Württemberg

Standpipes
Complete range for the connection
to the underground network
Germany- Netherlands- Belgium
Eastern Europe countries

Maximum working pressure: PN16
Material: aluminium alloy
Coating: polyester coating and hard anodisation
Body type: moulded and cut into bar

Standpipes with two outlets with valves

Standpipe with swivel upper part, 2 outlets with flywheel valves



**In compliance with the norm
DIN 14 375 - 2B**

TÜV certificate
Number PVR 3/97

Base (mm)	Outlets	Dimensions (mm)	Weight (kg)	Ref.
DN50	2x 2" AG male	330 x 104 x 967	5,29	07910
DN50	2x 2.5" AG male	330 x 104 x 1028	6,27	07911
DN50	2x Storz C/52	330 x 104 x 1022	5,87	07912
DN50	2x Storz B/75	330 x 126 x 1028	7,16	07913
DN80	2x 2" AG male	330 x 100 x 960	5,24	07906
DN80	2x 2.5" AG male	330 x 100 x 1022	6,22	07907
DN80	2x Storz C/52	330 x 100 x 960	5,81	07908
DN80	2x Storz B/75	330 x 126 x 1022	7,10	07909
DN80	2x Storz DN65 NEN 3374	330 x 118 x 1022	7,02	09228
DN80	2x DSP DN65, without lock	330 x 100 x 1022	6,84	07914

Standpipe with two outlets with flywheel valves - Württemberg version



Base (mm)	Outlets	Dimensions (mm)	Weight (kg)	Ref.
DN50	2x Storz C/52	330 x 104 x 1922	8,04	07915
DN50	2x Storz B/75	330 x 126 x 1928	9,22	07916

Standpipe with one outlet with screwdown valve

Standpipe with swivel upper part, 1 outlet with screwdown valve



Base (mm)	Outlet	Dimensions (mm)	Weight (kg)	Ref.
DN50	2" AG male	330 x 104 x 974	4,72	07900
DN50	Storz C/52	330 x 104 x 974	5,01	07899
DN80	2" AG male	330 x 100 x 967	4,67	07898
DN80	Storz C/52	330 x 100 x 967	4,96	07897
DN80	DSP DN65, without lock	330 x 100 x 967	5,03	07921

Standpipe without shutoff

Standpipe with swivel upper part, 1 outlet without shutoff



Base (mm)	Outlet	Dimensions (mm)	Weight (kg)	Ref.
DN50	Storz C/52	336 x 104 x 914	4,76	09000
DN50	Storz B/75	330 x 126 x 914	4,74	09001
DN80	2" AG male	330 x 100 x 907	4,41	07903
DN80	Storz C/52	336 x 100 x 907	4,70	07901
DN80	2.5" AG male	330 x 100 x 907	4,24	07904
DN80	Storz B/75	330 x 126 x 907	4,68	07902
DN80	DSP DN65, without lock	330 x 100 x 907	4,55	07905

Standpipe without shutoff

Standpipe with fixed upper part, 1 outlet without shutoff



Base(mm)	Outlet	Dimensions (mm)	Weight (kg)	Ref.
DN50	2" AG male	318 x 320 x 818	3,14	07920
DN50	Storz C/52	354 x 320 x 818	3,42	07919
DN80	2" AG male	320 x 320 x 823	3,37	07918
DN80	Storz C/52	357 x 320 x 823	3,66	07917

Standpipe with water meter

Standpipe with swivel upper part, with valve and water meter 5m³/h



Base (mm)	Outlet	Débit (m ³ /h)	Dimensions (mm)	Weight (kg)	Ref.
DN80	Mit Zapfventil	5		5,30	09539
DN80	Mit Zapfventil und absperung C Kupplung	5			09540

Standpipe with water meter without valve

Standpipe with swivel upper part, with valve and water meter 10m³/h



Base (mm)	Outlet	Débit (m ³ /h)	Dimensions (mm)	Weight (kg)	Ref.
DN80	Storz C/52	10			09536

Standpipes for British standard BS 750

Standpipe with swivel upper part, British standard BS 750



Base (mm)	Outlet	Dimensions (mm)	Weight (kg)	Ref.
DN80	Instantaneous 2.5" female	346 x 101 x 901	5,47	33818

Complete standpipe heads with two flywheel valves

Swivel upper part, 2 outlets with flywheel valves



Outlet	Dimensions (mm)	Weight (kg)	Ref.
2x Storz C/52	277 x 103 x 305	2,91	07996
2x Storz B/75	324 x 126 x 368	4,21	07997
2x 2" AG male	246 x 103 x 305	2,34	09259
2x 2.5" AG male	271 x 104 x 368	3,32	09260

Complete standpipe head without shutoff, two outlets male thread 2,5" BSP

Swivel upper part, 2 outlets without shutoff



Outlet	Dimensions (mm)	Weight (kg)	Ref.
2x Instantaneous 2.5" female	346 x 101 x 256	2,84	33821
2x 2.5" AG male	212 x 103 x 245	1,50	37108

Complete standpipe heads with one screwdown valve

Swivel upper part, 1 outlet with screwdown valve



Outlet	Dimensions (mm)	Weight (kg)	Ref.
2" AG male	180 x 103 x 312	1,78	09261

Complete standpipe heads without shutoff

Swivel upper part, 1 outlet without shutoff



Outlet	Dimensions (mm)	Weight (kg)	Ref.
2.5" AG male	186 x 103 x 252	1,35	09262

Complete standpipe bases

Lower part of DIN standpipe



Base (mm)	Dimensions (mm)	Weight (kg)	Ref.
DN50	330 x 104 x 697	2,97	07884
DN50	330 x 104 x 1597	5,14	07879
DN80	330 x 104 x 690	2,90	07514

Complete standpipe base with BS 336 connection

Lower part of DIN standpipe, British standard BS 750



Base (mm)	Dimensions (mm)	Weight (kg)	Ref.
DN80	330 x 104 x 680	2,63	33824

Plug for underground hydrant

Complete plug for fire hydrant



Connection	Dimensions (mm)	Weight (kg)	Ref.
DN80	150 x 102 x 155	1,07	07549

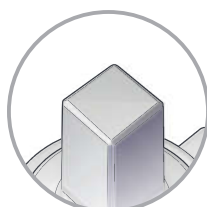

Square tip of 30x30 to 32x32

Standpipe foot

Complete standard foot



Outlet	Waterway Ø (mm)	Dimensions (mm)	Weight (kg)	Ref.
2" IG female	DN50	144 x 89 x 75	5,14	07548
2" IG female	DN80	105 x 102 x 80	2,97	07547
Whitworth Ø72 x 11 inch thread	DN80	105 x 102 x 80	2,90	07393

Handle for lower part

Handle for standpipe



Inlet	Dimensions (mm)	Weight (kg)	Ref.
2" IG female	292 x 104 x 75	0,70	07376
Whitworth Ø72 x 11 inch thread	330 x 104 x 75	0,72	07394

Flange

Plate to fix the upper part



Dimensions (mm)	Weight (kg)	Ref.
160 x 103 x 23	0,24	07588

Flange

Plate to fix the water meter



Outlet	Dimensions (mm)	Weight (kg)	Ref.
1" IG female	Ø90 x 70	0,74	09122
1.25" IG female	Ø90 x 70	0,70	09543
1.5" IG female	Ø90 x 70	0,64	09322

Gasket for standpipe foot

Gasket for standpipe foot



Waterway Ø (mm)	Dimensions (mm)	Weight (kg)	Ref.
80	Ø92 x Ø72 x 5	0,01	07396
50	Ø78 x Ø54 x 5	0,01	07885



90° Keyser elbows



Maximum working pressure: PN16
Material: aluminium alloy
Coating: polyester coating
Body type: moulded

Options: couplings inlet/outlet.

Our elbows "Keyser" allow the supply of the pump devices by hydrants. They are made of one half female type Keyser coupling on the inlet and one half DN40, DN65 or DN100 (according to the request) type DSP coupling on the outlet, other outlet coupling available on request. Made in primary aluminium alloy heat-treated.

Inlet	Outlet	Dimensions (mm)	Weight (kg)	Ref.
Keyser DN100 female	DSP DN40	295 x 178 x 258	2,30	07502
Keyser DN100 female	DSP DN65	272 x 178 x 263	3,38	07500
Keyser DN100 female	AR DN100	315 x 178 x 298	3,94	07501
Keyser DN100 female	AR DN100, with lock	355 x 178 x 288	4,47	07501.AV

Keyser valves with two outlets with flywheel valves



Maximum working pressure: PN16
Material: aluminium alloy
Coating: polyester coating
Body type: moulded

Options: couplings inlet/outlet.

Our valves "Keyser" can be assembled on a hydrant through a female Keyser coupling. They have two discharge pipes fitted with flywheel valves. A large number of in and outlet connections can be provided: threaded BSP or NST-NH, or standardised couplings.

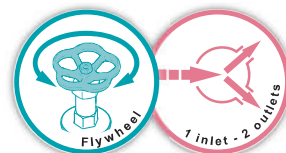

Inlet	Outlet	Dimensions (mm)	Weight (kg)	Ref.
Keyser DN100 female	2x DSP DN40	292 x 280 x 365	5,73	07510
Keyser DN100 female	2x DSP DN40, with lock	292 x 322 x 365	6,00	07510.AV
Keyser DN100 female	2x DSP DN50, with lock	292 x 301 x 365	5,80	16007
Keyser DN100 female	2x DSP DN65	292 x 238 x 365	5,40	02256
Keyser DN100 female	2x DSP DN65, with lock	292 x 284 x 365	6,05	02256.AV

Water supply elbows allows the modification of the orientation of the flow without any pressure loss. Our range of elbows is made of different diameters: 3/4" to 5". A large number of in and outlet connections can be provided: threaded BSP or NST-NH, or standardised couplings.

According to the model, it is made of one half coupling with locking on the inlet and of one half coupling with our without locking on the outlet.

Maximum working pressure: PN16
Material: aluminium alloy
Coating: untreated or polyester coating
Body type: bended moulded
Options: couplings inlet/outlet.

30° Elbows



Inlet	Outlet	Dimensions (mm)	Weight (kg)	Ref.
2.5" BSP male	2.5" BSP male	101 x 75 x 135	0,35	20861
4" BSP female	4" BSP male	134 x 126 x 121	0,73	20864
Flange DN100 PN16	Flange DN100 PN16	231 x 220 x 193	4,58	29340
5" BSP female	5" BSP male	170 x 165 x 166	1,28	32677
5" BSP female, swivel	5" BSP male	181 x 173 x 205	3,20	34755

45° Elbows



Inlet	Outlet	Dimensions (mm)	Weight (kg)	Ref.
4" BSP female	4" BSP male	157 x 123 x 166	0,91	32256

90° Elbows



Inlet	Outlet	Dimensions (mm)	Weight (kg)	Ref.
3/4" BSP male	3/4" BSP male	235 x 26 x 135	0,20	03942
1" BSP male	1" BSP male	94 x 35 x 94	0,16	01655
1.5" BSP male	ISO M45 x 150 female	140 x 50 x 150	0,25	03931
1.5" BSP male	1.5" BSP male	155 x 50 x 155	0,41	03932
1.5" BSP female	1.5" BSP female	143 x 55 x 143	0,42	03312
ISO M55 x 300 female, swivel	SG DN40, without lock	220 x 72 x 196	0,87	07485
ISO M55 x 300 female, swivel	DSP DN40, without lock	205 x 72 x 211	1,09	07486
ISO M55 x 300 female, swivel	DSP DN40, with lock	215 x 73 x 249	1,07	07486.AV
2" BSP male	2" BSP male	175 x 60 x 175	0,57	03930
2" BSP female	2" BSP female			26265
2.5" BSP male	ISO M70 x 150 female	212 x 75 x 212	0,86	03933
2.5" BSP male	2.5" BSP male	212 x 75 x 212	0,87	03934
3" BSP female	3" BSP female	161 x 95 x 161	0,80	26383
3" BSP female	3" BSP male	174 x 102 x 166	0,99	32724
3" BSP female	3" BSP female	163 x 95 x 163	0,76	03132
4" BSP female	4" BSP male	200 x 130 x 187	1,71	24699
6" BSP female	6" BSP male	362 x 180 x 355	6,24	33828
DSP DN40, with lock	DSP DN40, without lock	158 x 73 x 174	0,62	07490
DSP DN40, with lock	DSP DN40, with lock	198 x 73 x 173	0,76	07490.AV
SG DN40, with lock	SG DN40, without lock	152 x 72 x 164	0,53	07480
DSP DN65, with lock	DSP DN65, without lock	269 x 110 x 285	1,58	07491
DSP DN65, with lock	DSP DN65, with lock	315 x 107 x 287	1,91	07491.AV
SG DN65, with lock	SG DN65, without lock	264 x 105 x 286	1,55	07481
SG DN80, with lock	SG DN80, without lock	227 x 125 x 250	1,97	07488
AR DN100, with lock	AR DN100, without lock	272 x 152 x 273	3,40	07493
AR DN100, with lock	AR DN100, with lock	309 x 150 x 285	3,94	07493.AV
SG DN100, with lock	SG DN100, without lock	252 x 105 x 286	1,55	07483

180° Elbows



Inlet	Outlet	Dimensions (mm)	Weight (kg)	Ref.
2" BSP male	2" BSP male	300 x 60 x 180	1,04	07010

90° Elbowed reductions



Maximum working pressure: PN16
Material: aluminium alloy
Coating: polyester coating
Body type: moulded

Options: couplings inlet/outlet.

This water supply elbows allows the modification of the orientation of the flow without any pressure loss. A large number of in and outlet connections can be provided: threaded BSP or NST-NH, or standardised couplings.

Inlet	Outlets	Dimensions (mm)	Weight (kg)	Réf.
4" BSP female	2.5" BSP male	300 x 60 x 180	1,28	25459
ISO M55 x 300 female, swivel	Express DN25	160 x 71 x 220	0,61	07487
DSP DN65, with lock	DSP DN40, without lock	302 x 107 x 301	1,92	26469
DSP DN65, with lock	SG DN40, with lock	335 x 107 x 301	2,07	26469.AV
AR DN100, with lock	DSP DN65, without lock	291 x 136 x 306	2,35	07492
SG DN100, with lock	SG DN65, without lock	287 x 136 x 308	2,27	07482
SG DN100, with lock	SG DN65, with lock	264 x 152 x 261	2,92	07492.AV

90° Elbows - bronze



Maximum working pressure: PN16
Material: bronze
Coating: untreated
Body type: moulded

Options: couplings inlet/outlet.

This water supply elbow is made of bronze for use in salty atmosphere.

It allows the modification of the orientation of the flow without any pressure loss. It is made of one half coupling with locking ring on the inlet and of one half coupling without locking ring on the outlet.

Inlet	Outlet	Dimensions (mm)	Weight (kg)	Ref.
SG DN65, with lock	SG DN65, without lock	210 x 105 x 240	3,50	02839
SG DN100, with lock	SG DN100, without lock			07484

